

Glendale Corporate Center

Prominent Ground Floor Retail Available For Lease

Ideal For Financial, Salon, Medical, Gym And Creative Office Use



425 E. Colorado Street

Glendale, CA

Property Highlights:

- Prominent Ground Floor Retail Spaces of 8,446 & 9,622 Sq.Ft.
- Central Downtown Location Within Walking Distance to Americana at Brand along with numerous restaurants and retail amenities.
- Easy Access to the 134, 2, and 5 Freeways.
- 370 On Site Parking Spaces (3.14 / 1000)
- Dramatic High Ceilings with Up to 24 Feet Clear Ht.

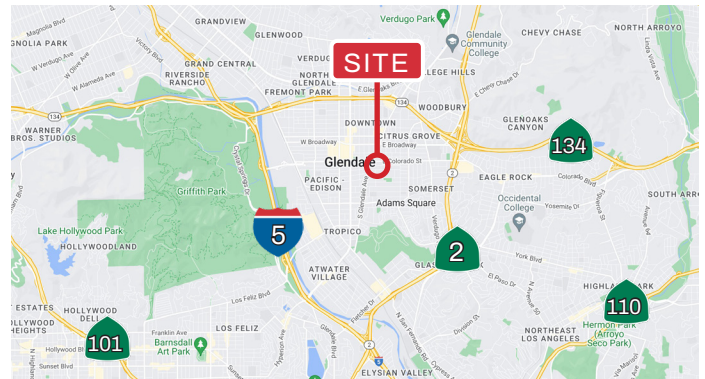

Traffic Count

Colorado St	26,900
Jackson St	None Available
TOTAL	26,900

FOR MORE INFORMATION:

Steven H. Weiss
Executive Vice President
818 905 2400 Ext. 134
sweiss@naicapital.com
Cal DRE License #0068554

15821 Ventura Blvd.
Suite 320
Encino, CA 91436
818 905 2400
naicapital.com

DEMOGRAPHICS	1 MILES	2 MILES	3 MILES
TOTAL POPULATION	73,791	149,451	229,237
AVG. HH INCOME	\$75,502	\$97,341	\$113,991
NO. OF EMPLOYEES	42,235	91,069	123,635

Floor Plan

Glendale Corporate Center

Prominent Ground Floor Retail
Available For Lease

*Ideal For Financial, Salon, Medical, Gym And
Creative Office Use*

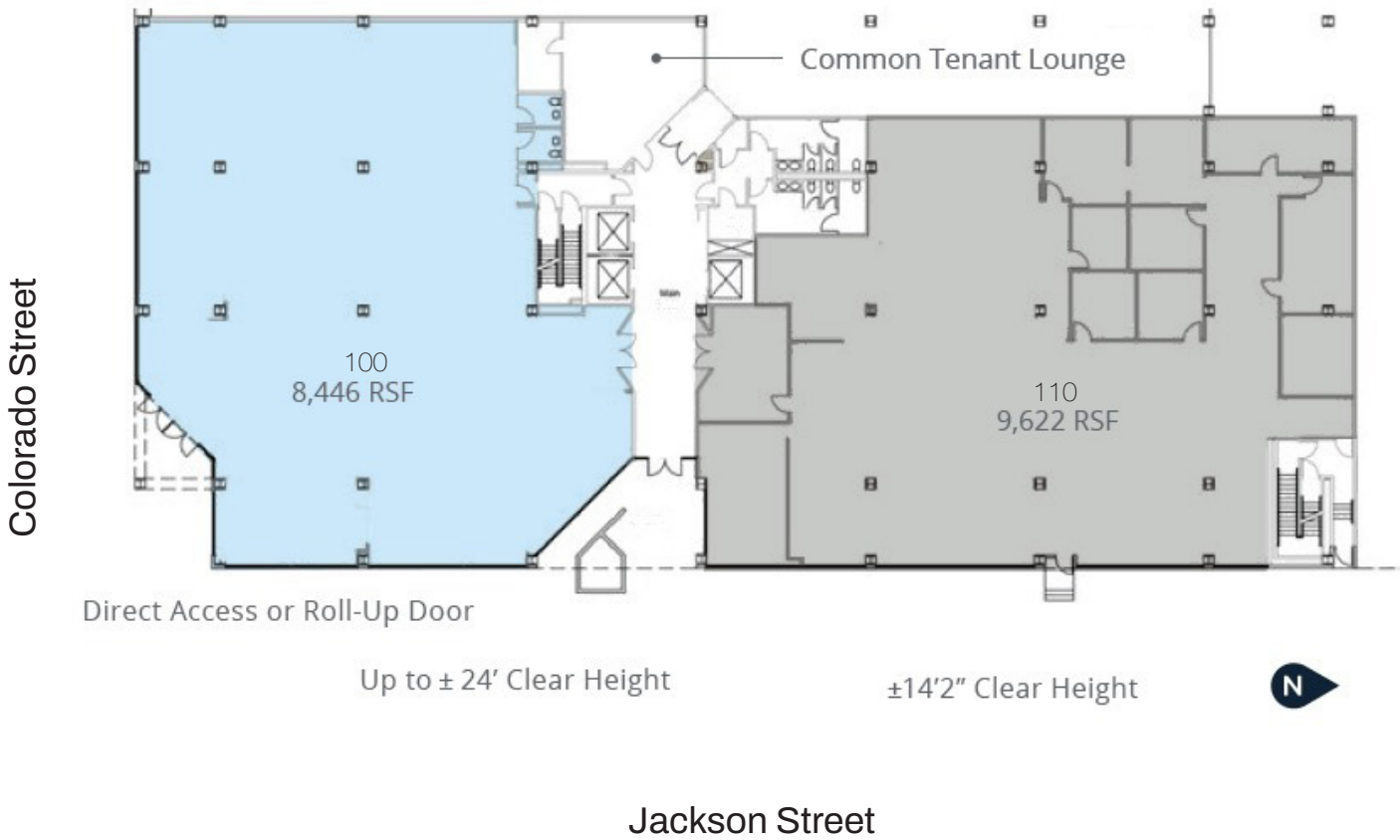

Steven H. Weiss

Executive Vice President | 818 905 2400 Ext. 134
sweiss@naicapital.com | Cal DRE License #0068554