

FOR LEASE | Former JOANN Fabrics Store

2086-A Foothill Blvd., La Verne, CA 91750

AVAILABLE
+/- 11,350 SF

STATER BROS.
markets

IN-N-OUT
BURGER

D ST

FOOTHILL BLVD

Steven Berman

Vice President

818 815 2412

sberman@naicapital.com

CA DRE Lic #00967188

Jesse Paster

Vice President

818 742 1624

jpaster@naicapital.com

CA DRE Lic #01316106

NAI Capital Commercial

15821 Ventura Blvd, Suite #320

Encino, CA 91436

818 905 2400

www.naicapital.com

NAI Capital
COMMERCIAL REAL ESTATE SERVICES, WORLDWIDE



- Inline ±11,350 SF retail space within ± 39,658 SF shopping center, including Chase Bank & Little Caesars. Shadow anchored by Stater Brothers with In-N-Out Burgers on the out-corner driving traffic and sales. Over 300 Parking Stalls.
- Well located within the heart of the La Verne retail district with an average household Income over \$104,000 and population over 101,000 within a 3-mile radius with immediate proximity to Buena High School.
- Prime visibility along Foothill Blvd (Rte. 66) with convenient access to the Foothill (210) Freeway, to the west at Foothill Boulevard and to the east at White Avenue, with a traffic count over 35,000 CPD.

SITE PLAN - 2080 Foothill Blvd., La Verne, CA

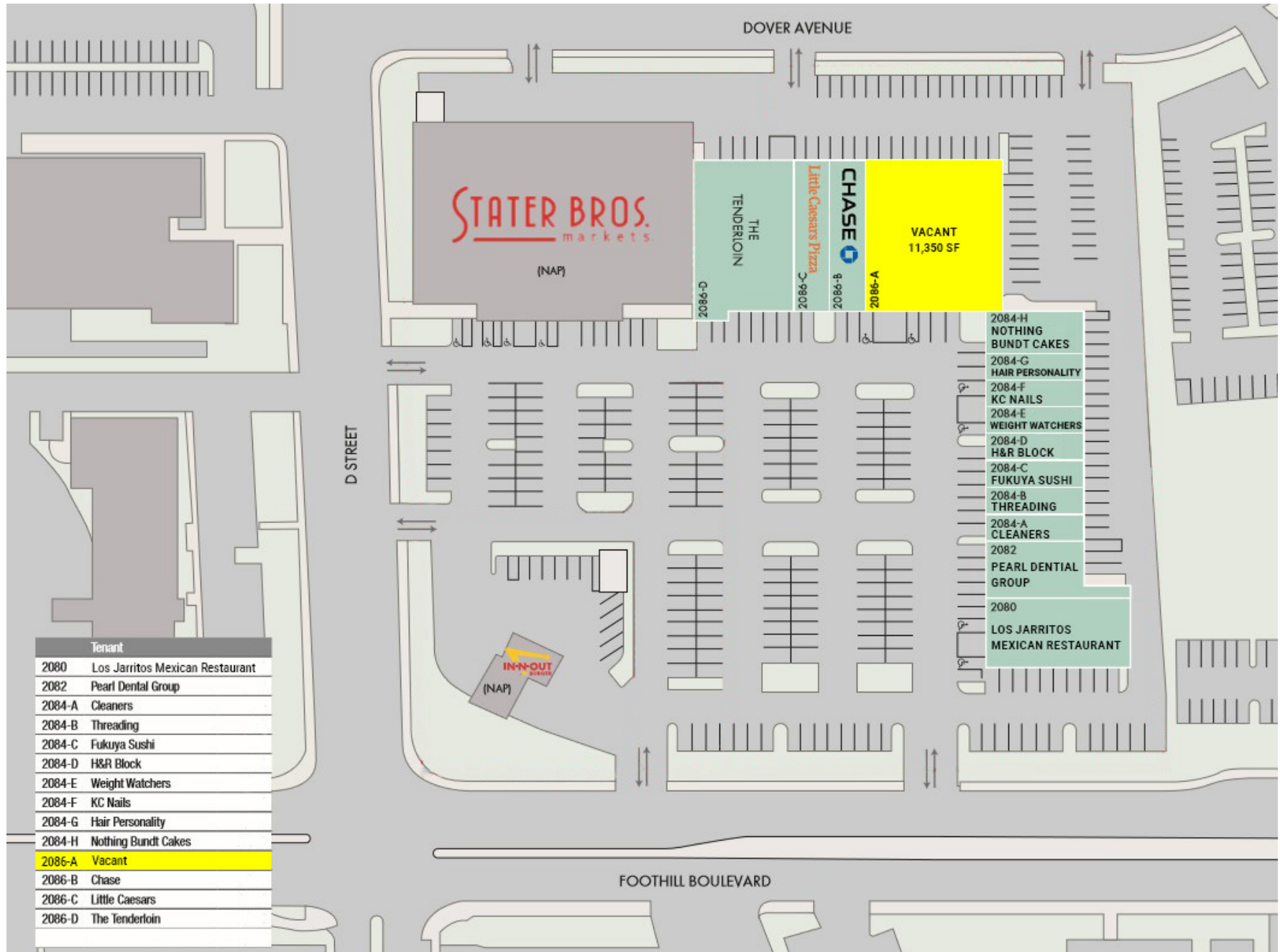

FLOOR PLAN - Unit A

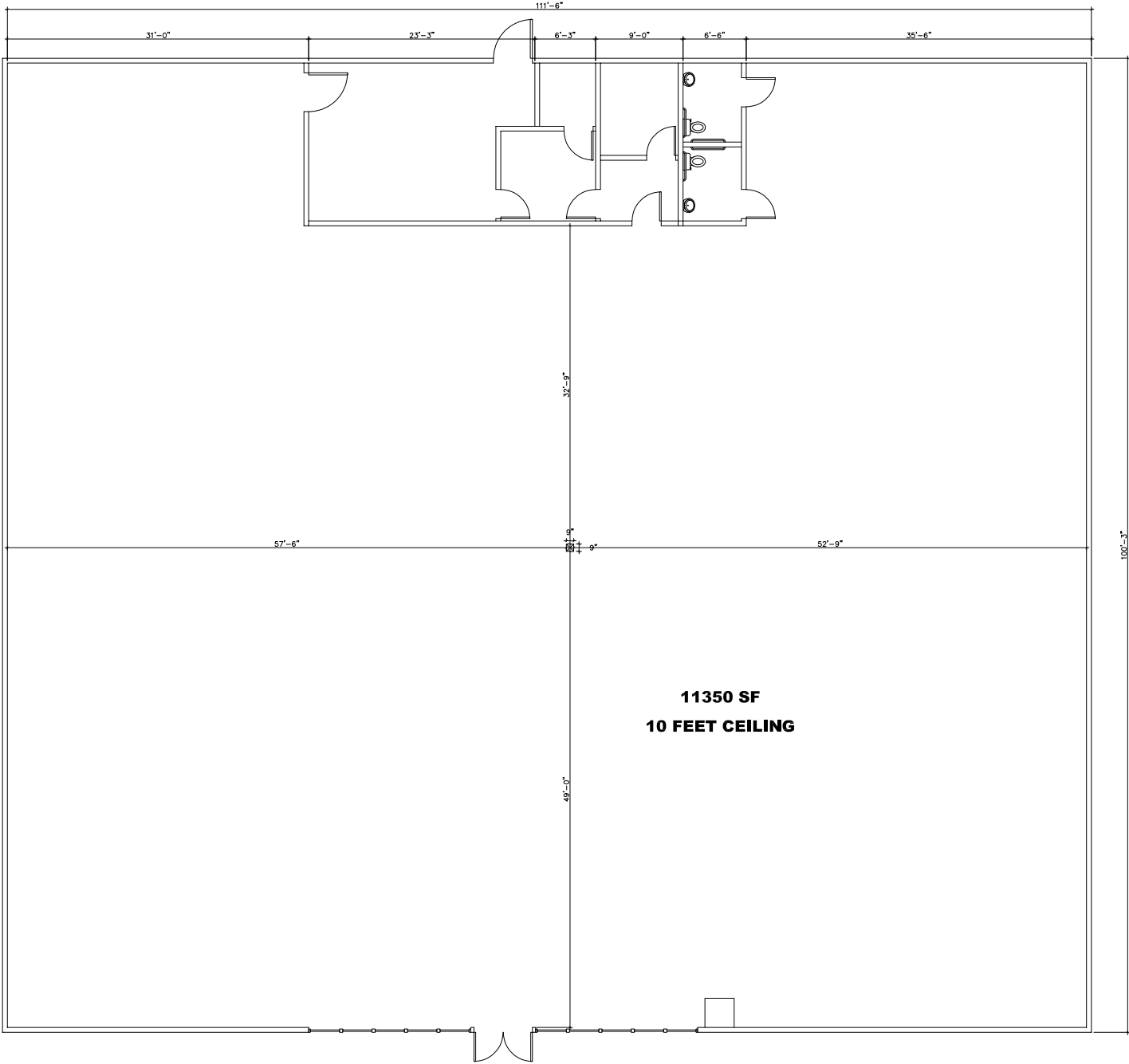

INTERIOR PHOTOS



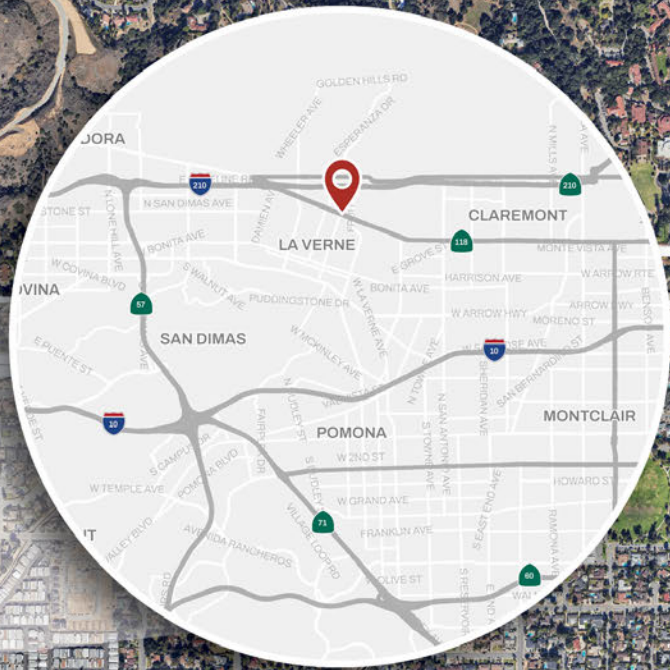

LA VERNE

LA VERNE OVERVIEW

La Verne is a “close-knit” community which has been able to retain its “small town” traditions that captures the essence of Southern California living with its warm climate, picturesque landscapes, and a community that radiates charm and friendliness. Nestled in the San Gabriel Valley, La Verne offers a serene and laid-back atmosphere with inviting parks and engaging activities with an array of unique businesses and delightful dining options.

DEMOGRAPHICS	1 MILE	2 MILES	3 MILES
Total Population	17,653	55,164	101,071
Total Households	7,112	19,954	35,611
Average HH Income	\$98,594	\$100,746	\$104,956
Average House Value	\$465,999	\$516,078	\$556,538



EXCLUSIVELY LISTED BY:

Steven Berman

Vice President

818 815 2412

sberman@naicapital.com

CA DRE Lic #00967188

Jesse Paster

Vice President

818 742 1624

jpaster@naicapital.com

CA DRE Lic #01316106

NAI Capital Commercial

15821 Ventura Blvd, Suite #320

Encino, CA 91436

818 905 2400

www.naicapital.com

No warranty, express or implied, is made as to the accuracy of the information contained herein. This information is submitted subject to errors, omissions, change of price, rental or other conditions, withdrawal without notice, and is subject to any special listing conditions imposed by our principals. Cooperating brokers, buyers, tenants and other parties who receive this document should not rely on it, but should use it as a starting point of analysis, and should independently confirm the accuracy of the information contained herein through a due diligence review of the books, records, files and documents that constitute reliable sources of the information described herein. NAI Capital CA DRE #02130474

NAI Capital
COMMERCIAL REAL ESTATE SERVICES, WORLDWIDE