



Institutionally Owned & Managed / Flexibility to Expand  
Convenient Access to the 101 Freeway



**2,932 & 2,936 SF AVAILABLE FOR LEASE**

**HIGHLY SOUGHT AFTER TARZANA INDUSTRIAL UNITS**

18314 Oxnard Street, Unit 4 | 18324 Oxnard Street, Unit 4  
Tarzana, Ca | Los Angeles County



# Building



## Property Highlights

- Lease Rate: \$2.00 MG: OpEx \$0.15 CAM
- Clear Height: 16'
- 1 Ground Level Door
- 10x14 Rollup Door
- 1 ADA Restroom
- Excellent Southern Valley Location
- Close to the 101 Freeway

## 18314 Unit 4, 2,936 Overall

- Warehouse SF - 2,960 SF
- Office SF - 246 SF
- Available, October 1, 2024

## 18324 Unit 4, 2,932 Overall

- Warehouse SF - 2,667 SFF
- Office SF - 265 SF
- Available Now



# Property Photos



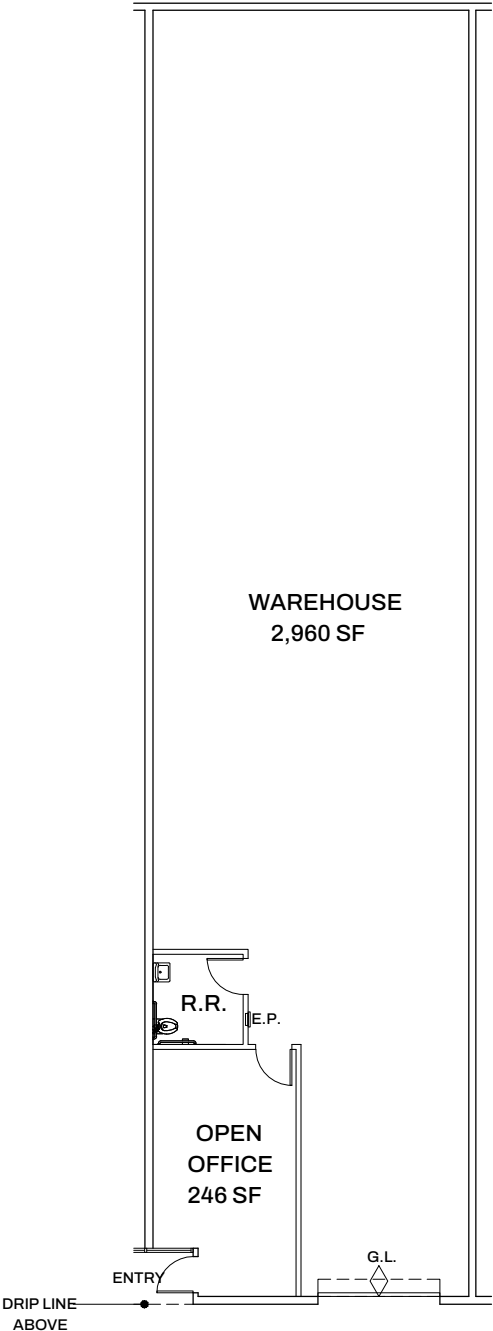

**WAREHOUSE**  
2,960 SF

**OFFICE**  
246 SF

**TOTAL**  
2,963 SF

Plan layout subject to field conditions and may differ from plan as shown. All information presented on this drawing is presumed to be accurate, however tenant should verify pertinent information prior to committing to a lease. Any furniture or appliances shown on plan are for concept only and will be tenant provided.

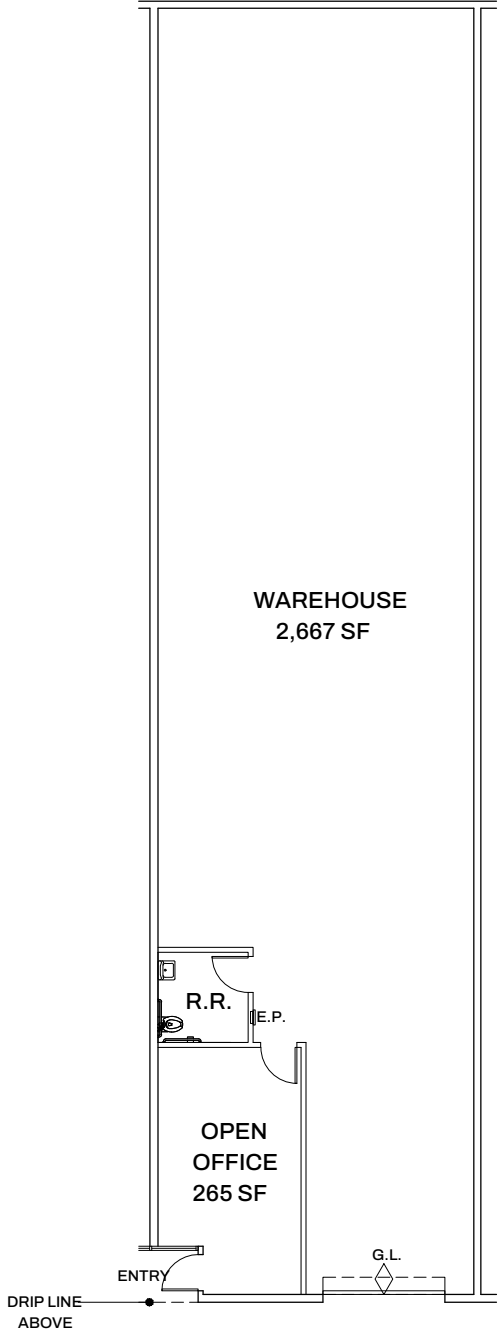

**WAREHOUSE**  
2,667 SF

**OFFICE**  
265 SF

**TOTAL**  
2,932 SF

Plan layout subject to field conditions and may differ from plan as shown. All information presented on this drawing is presumed to be accurate, however tenant should verify pertinent information prior to committing to a lease. Any furniture or appliances shown on plan are for concept only and will be tenant provided.

# Location

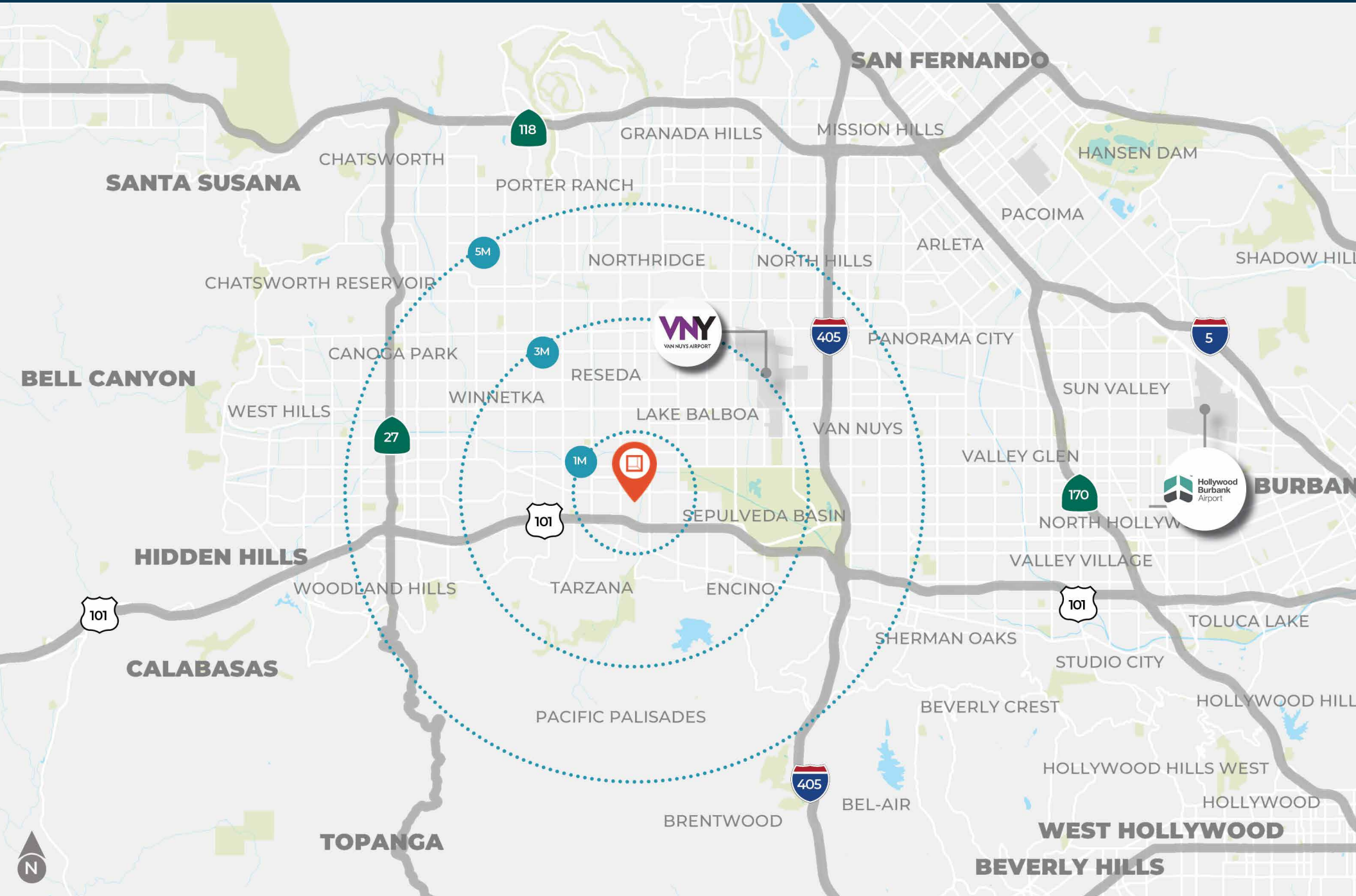

# Amenities Map





**Rexford  
Industrial**

## Leasing Contact

**Matt Ehrlich**  
Executive Vice President  
818-933-2364  
mehrlich@naiglobal.com  
Cal DRE Lic #01936772



15821 Ventura Boulevard  
Suite 320  
Encino, California 91436

No warranty, express or implied, is made as to the accuracy of the information contained herein. This information is submitted subject to errors, omissions, change of price, rental or other conditions, withdrawal without notice, and is subject to any special listing conditions imposed by our principals. Cooperating brokers, buyers, tenants and other parties who receive this document should not rely on it, but should use it as a starting point of analysis, and should independently confirm the accuracy of the information contained herein through a due diligence review of the books, records, files and documents that constitute reliable sources of the information described herein. NAI Capital CA DRE #02130474