

# 9045 SANTA MONICA BLVD. WEST HOLLYWOOD 90069

NEW CONSTRUCTION TURN KEY RESTAURANT & PATIO IN WeHo



**JARED SWEDELSON**

Vice President  
d: 818-742-1632  
m: 818-644-7597  
jswedelson@naicapital.com  
Cal DRE Lic #02105146

**NAI CAPITAL - WEST LOS ANGELES**

11835 W. Olympic Blvd., Suite 700E  
Los Angeles, CA 90064  
d: 310-806-6100  
f: 310-806-6101  
www.naicapital.com

**NAI Capital**  
COMMERCIAL REAL ESTATE SERVICES, WORLDWIDE

# Building Details



## Price:

\$16,000/mo NNN

## Key Money:

Negotiable

## Year Built:

2022 (new equipment and finishes)

## Parking:

On-site with reserved spaces and valet capability

## Building Features

- Type 2 hood
- Grease interceptor
- Walk-in cooler
- 3 compartment sink
- Mop sink
- 2 ADA restrooms

## Location SF:

Interior:	1,450 SF
Exterior:	633 SF
	<b>2,083 SF</b>

## Key Highlights:

- Newly built restaurant
- Indoor/outdoor capabilities with retractable glass door
- Amazing signage opportunity on the corner of Santa Monica Blvd X Nemo Street
- Next to Dan Tana's, Doheny Room, and Olivetta

# Property Photos



# Property Photos



# Floor Plan

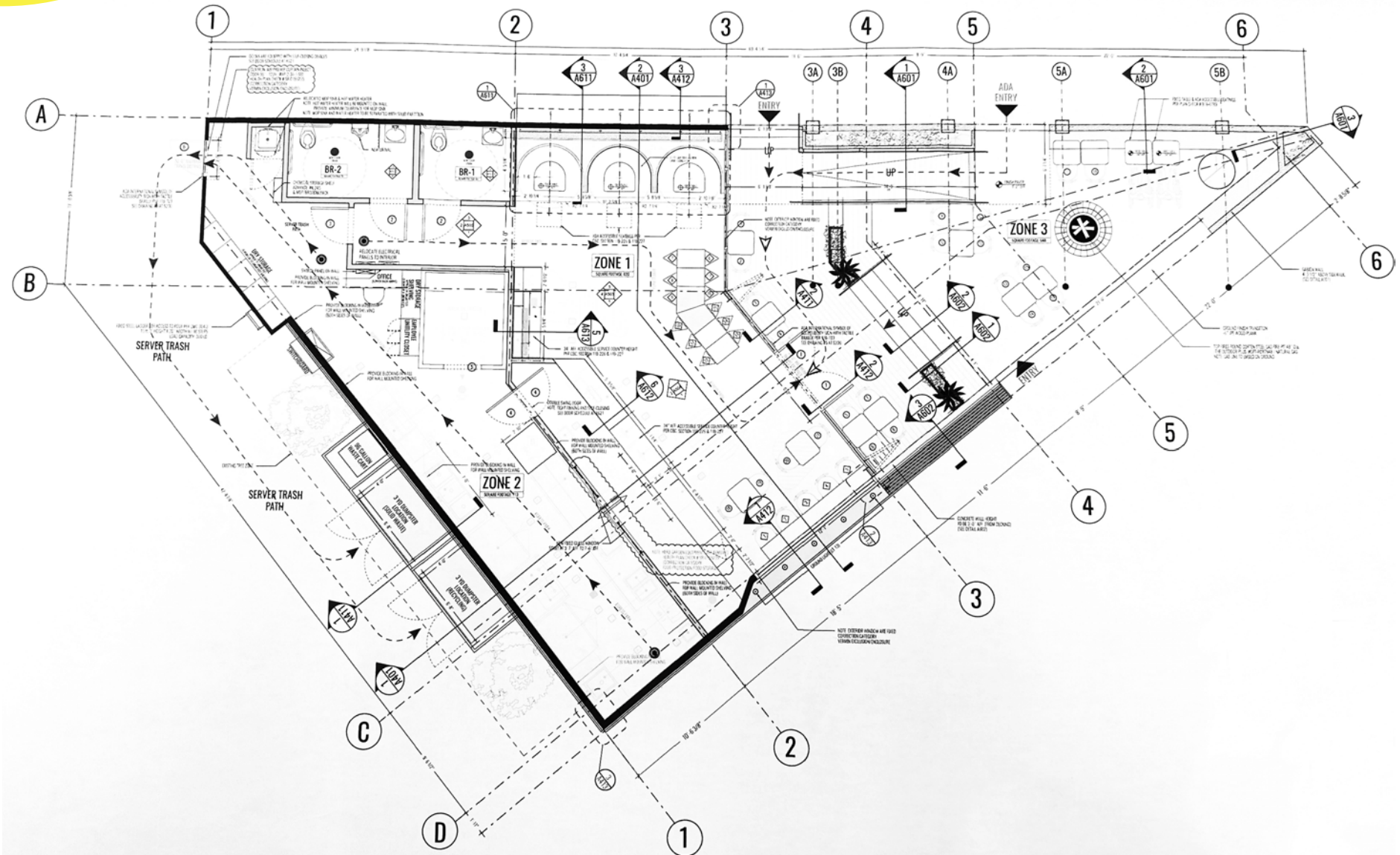

# Aerial Map



BEVERLY HILLS

WEST HOLLYWOOD

SITE

MELROSE TRIANGLE

SANTA MONICA BLVD

N ALMONT DR

Troubadour

BR  
AVO

DOHENY ROOM

Dan Tana's

Olivetta

GANNI

VERVE  
COFFEE ROASTERS

# Contact Info

## JARED SWEDELSON

Vice President  
d: 818-742-1632  
m: 818-644-7597  
jswedelson@naicapital.com  
Cal DRE Lic #02105146

## NAI CAPITAL - WEST LOS ANGELES

11835 W. Olympic Blvd., Suite 700E  
Los Angeles, CA 90064  
d: 310-806-6100  
f: 310-806-6101  
www.naicapital.com

No warranty, express or implied, is made as to the accuracy of the information contained herein. This information is submitted subject to errors, omissions, change of price, rental or other conditions, withdrawal without notice, and is subject to any special listing conditions imposed by our principals. Cooperating brokers, buyers, tenants and other parties who receive this document should not rely on it, but should use it as a starting point of analysis, and should independently confirm the accuracy of the information contained herein through a due diligence review of the books, records, files and documents that constitute reliable sources of the information described herein. NAI Capital Cal DRE #02130474