

1345 Third Street Promenade

Santa Monica, California 90401

Property Features

- 41-story, ±616,938 RSF, premier office tower located in the heart of the Financial District
- Institutional ownership and management
- LEED® EBOM Gold certified building
- 3-story historical Conservatory with fountain and seating for tenant enjoyment
- Direct building elevator access to BART and Muni
- On-site Club One fitness facility
- Cardkey security access to all floors
- 24 hours, 7 days a week on-site security
- <http://www2.naicapital.com/>

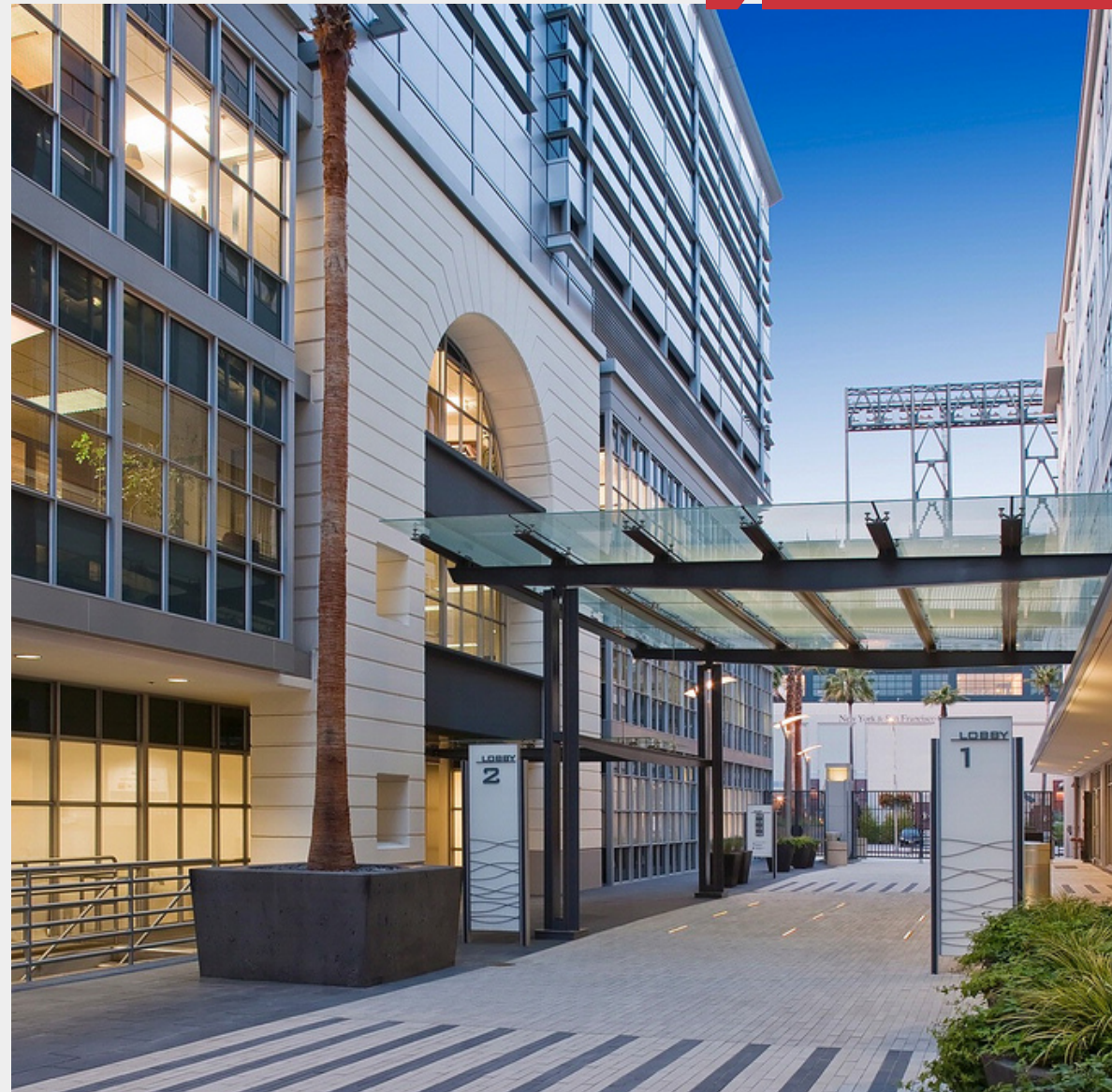



Property Details

Sale Price	\$50,000,000
Cap Rate	9.55%
NOI	\$4,774,709
Lot Size	0.5 Acres
Building Size	500,000 SF
Building Class	A
Year Built	2007
Renovated	2010
Zoning	B-1 / B-2
Market	San Francisco Metro
Sub Market	Silicon Valley
Cross Streets	Liberty & Cadwalader

Property Overview

China Basin at 185 Berry Street represents an exceptional opportunity for office use, life science, and technology companies seeking to combine a campus environment, waterfront location at the gateway to Mission Bay, and the highest quality tenant services and amenities. The China Basin campus is comprised of two structures, the six-story Wharftside Building and the five-story Berry Building, connected by a landscaped, open-air courtyard. A two-story, 175,000 sq. ft. addition to the Berry Building was recently completed. The Berry Building addition was carefully designed to meet the needs of a variety of users, from life science and technology firms to corporate offices. The efficient, rectangular floor plates can be transformed readily into laboratory space, classrooms or offices.

Property Highlights

- 41-story, ±616,938 RSF, premier office tower located in the heart of the Financial District
- Institutional ownership and management
- LEED® EBOM Gold certified building
- 2-story historical Conservatory with fountain and seating for tenant enjoyment

For Sale

Office
500,000 SF

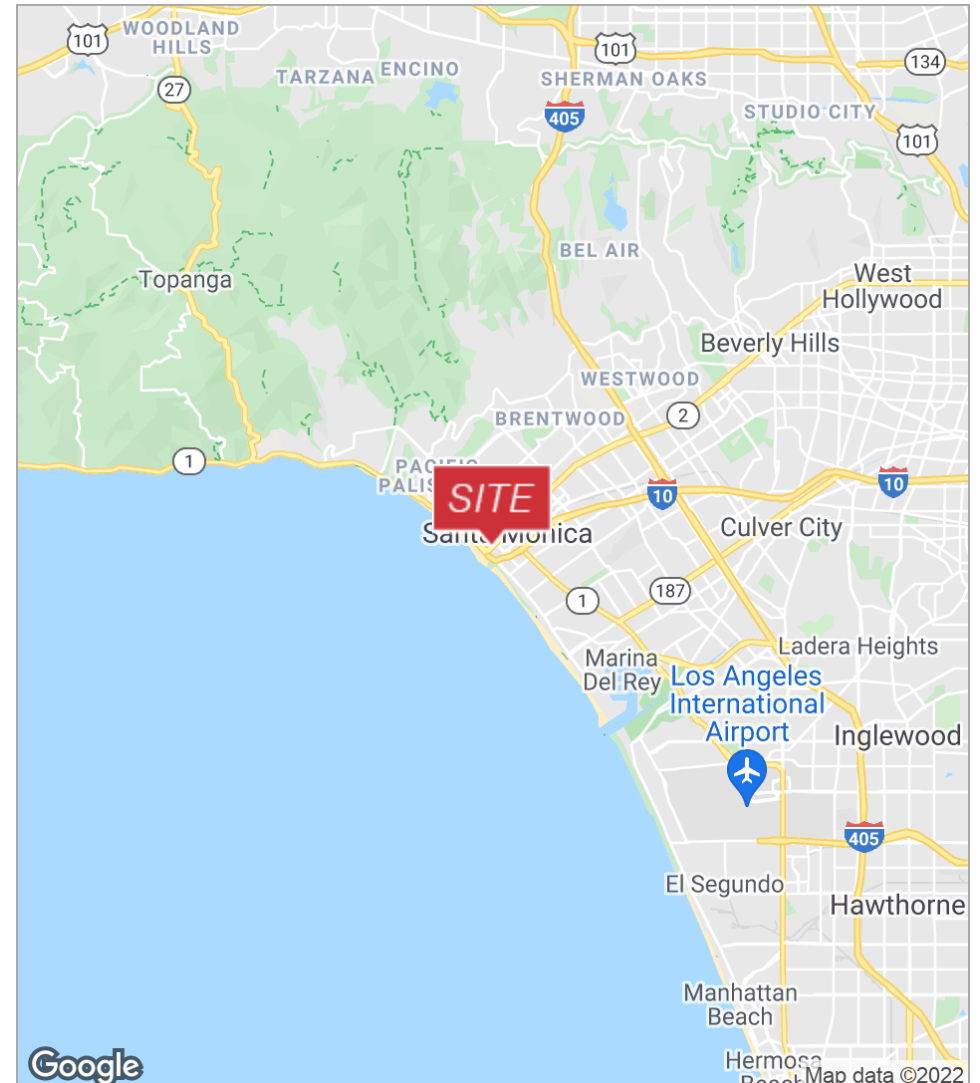
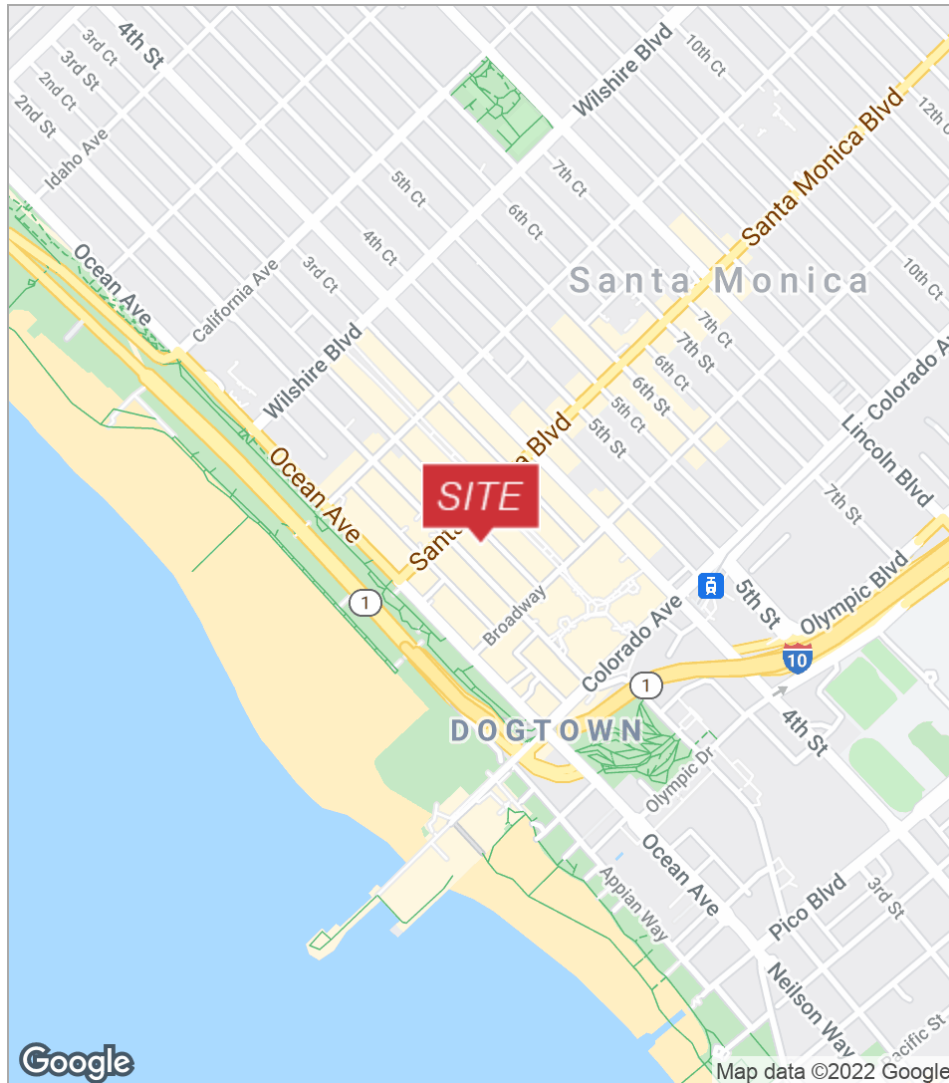

NO WARRANTY, EXPRESS OR IMPLIED, IS MADE AS TO THE ACCURACY OF THE INFORMATION CONTAINED HEREIN. THIS INFORMATION IS SUBMITTED SUBJECT TO ERRORS, OMISSIONS, CHANGE OF PRICE, RENTAL OR OTHER CONDITIONS, WITHDRAWAL WITHOUT NOTICE, AND IS SUBJECT TO ANY SPECIAL LISTING CONDITIONS IMPOSED BY OUR PRINCIPALS. COOPERATING BROKERS, BUYERS, TENANTS AND OTHER PARTIES WHO RECEIVE THIS DOCUMENT SHOULD NOT RELY ON IT, BUT SHOULD USE IT AS A STARTING POINT OF ANALYSIS, AND SHOULD INDEPENDENTLY CONFIRM THE ACCURACY OF THE INFORMATION CONTAINED HEREIN THROUGH A DUE DILIGENCE REVIEW OF THE BOOKS, RECORDS, FILES AND DOCUMENTS THAT CONSTITUTE RELIABLE SOURCES OF THE INFORMATION DESCRIBED HEREIN. LOGOS ARE FOR IDENTIFICATION PURPOSES ONLY AND MAY BE TRADEMARKS OF THEIR RESPECTIVE COMPANIES. NAI CAPITAL, INC. CAL DRE LIC. #02130474

Chris Jackson
 818.933.2368
 cjackson@naicapital.com
 CalDRE #01255538

NAI Capital
 15821 Ventura Blvd.
 Encino, CA 91436
 818.905.2400
www.naicapital.com



NO WARRANTY, EXPRESS OR IMPLIED, IS MADE AS TO THE ACCURACY OF THE INFORMATION CONTAINED HEREIN. THIS INFORMATION IS SUBMITTED SUBJECT TO ERRORS, OMISSIONS, CHANGE OF PRICE, RENTAL OR OTHER CONDITIONS, WITHDRAWAL WITHOUT NOTICE, AND IS SUBJECT TO ANY SPECIAL LISTING CONDITIONS IMPOSED BY OUR PRINCIPALS. COOPERATING BROKERS, BUYERS, TENANTS AND OTHER PARTIES WHO RECEIVE THIS DOCUMENT SHOULD NOT RELY ON IT, BUT SHOULD USE IT AS A STARTING POINT OF ANALYSIS, AND SHOULD INDEPENDENTLY CONFIRM THE ACCURACY OF THE INFORMATION CONTAINED HEREIN THROUGH A DUE DILIGENCE REVIEW OF THE BOOKS, RECORDS, FILES AND DOCUMENTS THAT CONSTITUTE RELIABLE SOURCES OF THE INFORMATION DESCRIBED HEREIN. LOGOS ARE FOR IDENTIFICATION PURPOSES ONLY AND MAY BE TRADEMARKS OF THEIR RESPECTIVE COMPANIES. NAI CAPITAL, INC. CAL DRE LIC. #02130474

Chris Jackson
818.933.2368
cjackson@naicapital.com
CalDRE #01255538

NAI Capital
15821 Ventura Blvd.
Encino, CA 91436
818.905.2400
www.naicapital.com

Property Overview

China Basin at 185 Berry Street represents an exceptional opportunity for office use, life science, and technology companies seeking to combine a campus environment, waterfront location at the gateway to Mission Bay, and the highest quality tenant services and amenities. The China Basin campus is comprised of two structures, the six-story Wharfside Building and the five-story Berry Building, connected by a landscaped, open-air courtyard. A two-story, 175,000 sq. ft. addition to the Berry Building was recently completed. The Berry Building addition was carefully designed to meet the needs of a variety of users, from life science and technology firms to corporate offices. The efficient, rectangular floor plates can be transformed readily into laboratory space, classrooms or offices.

Location Overview

An exceptional location both for business and life after-hours, China Basin is directly across the street from the San Francisco Giants' ballpark. This venue also hosts concerts, collegiate sports and other entertainment events throughout the year. Dining in is easy with a full-service grocery store located one block from the campus. Choose from the many restaurants that cater equally to the weekday and weekend crowds, with outdoor decks, weekend brunch, and a sizzling night scene. Outdoor recreation is a highlight of Mission Bay. The Embarcadero, a popular route for joggers, inline skaters and bicyclists, is two blocks from China Basin. There are also numerous public parks and trails nearby.



PROPERTY NAME:	The Mobi Building [DEMO]
PROPERTY ADDRESS:	1345 Third Street Promenade Santa Monica, CA 90401
PROPERTY TYPE:	Office
APN:	384-553-44
LOT SIZE:	0.5 Acres
BUILDING CLASS:	A
ZONING:	B-1 / B-2
PARKING SPACES:	455
PARKING RATIO:	3.0
BUILDING FRONTAGE:	
CROSS STREETS:	Liberty & Cadwalader
YEAR BUILT:	2007
CONSTRUCTION TYPE:	
NUMBER OF STORIES:	12
AVERAGE FLOOR SIZE:	
FOUNDATION:	
WALLS:	
NUMBER OF UNITS:	18
ROOF:	

Property Highlights

- 41-story, ±616,938 RSF, premier office tower located in the heart of the Financial District
- Institutional ownership and management
- LEED® EBOM Gold certified building
- 3-story historical Conservatory with fountain and seating for tenant enjoyment
- Direct building elevator access to BART and Muni
- On-site Club One fitness facility
- Cardkey security access to all floors
- 24 hours, 7 days a week on-site security
- <http://www2.naicapital.com/>





NO WARRANTY, EXPRESS OR IMPLIED, IS MADE AS TO THE ACCURACY OF THE INFORMATION CONTAINED HEREIN. THIS INFORMATION IS SUBMITTED SUBJECT TO ERRORS, OMISSIONS, CHANGE OF PRICE, RENTAL OR OTHER CONDITIONS, WITHDRAWAL WITHOUT NOTICE, AND IS SUBJECT TO ANY SPECIAL LISTING CONDITIONS IMPOSED BY OUR PRINCIPALS. COOPERATING BROKERS, BUYERS, TENANTS AND OTHER PARTIES WHO RECEIVE THIS DOCUMENT SHOULD NOT RELY ON IT, BUT SHOULD USE IT AS A STARTING POINT OF ANALYSIS, AND SHOULD INDEPENDENTLY CONFIRM THE ACCURACY OF THE INFORMATION CONTAINED HEREIN THROUGH A DUE DILIGENCE REVIEW OF THE BOOKS, RECORDS, FILES AND DOCUMENTS THAT CONSTITUTE RELIABLE SOURCES OF THE INFORMATION DESCRIBED HEREIN. LOGOS ARE FOR IDENTIFICATION PURPOSES ONLY AND MAY BE TRADEMARKS OF THEIR RESPECTIVE COMPANIES. NAI CAPITAL, INC. CAL DRE LIC. #02130474

Chris Jackson
818.933.2368
cjackson@naicapital.com
CalDRE #01255538

NAI Capital
15821 Ventura Blvd.
Encino, CA 91436
818.905.2400
www.naicapital.com



NO WARRANTY, EXPRESS OR IMPLIED, IS MADE AS TO THE ACCURACY OF THE INFORMATION CONTAINED HEREIN. THIS INFORMATION IS SUBMITTED SUBJECT TO ERRORS, OMISSIONS, CHANGE OF PRICE, RENTAL OR OTHER CONDITIONS, WITHDRAWAL WITHOUT NOTICE, AND IS SUBJECT TO ANY SPECIAL LISTING CONDITIONS IMPOSED BY OUR PRINCIPALS. COOPERATING BROKERS, BUYERS, TENANTS AND OTHER PARTIES WHO RECEIVE THIS DOCUMENT SHOULD NOT RELY ON IT, BUT SHOULD USE IT AS A STARTING POINT OF ANALYSIS, AND SHOULD INDEPENDENTLY CONFIRM THE ACCURACY OF THE INFORMATION CONTAINED HEREIN THROUGH A DUE DILIGENCE REVIEW OF THE BOOKS, RECORDS, FILES AND DOCUMENTS THAT CONSTITUTE RELIABLE SOURCES OF THE INFORMATION DESCRIBED HEREIN. LOGOS ARE FOR IDENTIFICATION PURPOSES ONLY AND MAY BE TRADEMARKS OF THEIR RESPECTIVE COMPANIES. NAI CAPITAL, INC. CAL DRE LIC. #02130474

Chris Jackson
818.933.2368
cjackson@naicapital.com
CalDRE #01255538

NAI Capital
15821 Ventura Blvd.
Encino, CA 91436
818.905.2400
www.naicapital.com



It turns out, you don't have any Plans Published!

(be sure to add floor plans in the [Property Edit Form](#))

Population	0.25 Miles	0.5 Miles	1 Mile
TOTAL POPULATION	6,668	26,974	97,166
MEDIAN AGE	41.2	39.0	38.0
MEDIAN AGE (MALE)	38.9	37.9	38.2
MEDIAN AGE (FEMALE)	43.7	40.6	37.9

Households & Income	0.25 Miles	0.5 Miles	1 Mile
TOTAL HOUSEHOLDS	3,442	13,717	52,175
# OF PERSONS PER HH	1.9	2.0	1.9
AVERAGE HH INCOME	\$60,872	\$73,347	\$95,378
AVERAGE HOUSE VALUE	\$799,399	\$779,222	\$855,431

Race	0.25 Miles	0.5 Miles	1 Mile
% WHITE	44.4%	51.1%	61.8%
% BLACK	28.3%	22.1%	11.8%
% ASIAN	19.6%	19.2%	18.1%
% HAWAIIAN	0.0%	0.0%	0.1%
% INDIAN	0.3%	0.4%	0.3%
% OTHER	4.0%	4.0%	4.0%

Ethnicity	0.25 Miles	0.5 Miles	1 Mile
% HISPANIC	12.4%	11.9%	11.6%

