

For Lease

# 19855 Ventura Boulevard

Woodland Hills, CA 91364



## HIGHLIGHTS

- 2-Story, Open Floor Plan
- Unique Façade
- 36K Daily Traffic
- Freeway Visibility, Signalized Corner
- 10,757 Sq. Ft. on 12,000 Sq. Ft. Lot
- Shower Area and Two Restrooms Upstairs
- Lease Price: \$1.59/Sq. Ft + \$.37 NNN

Demographics	1 Mile	3 Miles	5 Miles
POPULATION	17,217	215,166	463,650
AVG HH INCOME	\$137,000	\$95,000	\$96,000



**NAI Capital**  
Commercial Real Estate Services, Worldwide.

No warranty, express or implied, is made as to the accuracy of the information contained herein. This information is submitted subject to errors, omissions, change of price, rental or other conditions, withdrawal without notice, and is subject to any special listing conditions imposed by our principals. Cooperating brokers, buyers, tenants and other parties who receive this document should not rely on it, but should use it as a starting point of analysis, and should independently confirm the accuracy of the information contained herein through a due diligence review of the books, records, files and documents that constitute reliable sources of the information described herein.



For information, please contact your exclusive listing agent:  
**J. Richard Leyner**  
 Senior Vice President  
 818 742 1638  
 jrleyner@naicapital.com  
 DRE #00716540

16001 Ventura Blvd., Suite 200  
 Encino, California 91436  
 tel 818 905 2400  
 fax 818 905 2425  
 www.naicapital.com

For Lease

# 19855 Ventura Boulevard

Woodland Hills, CA 91364

19855 Ventura Boulevard, Woodland Hills | Ground Floor

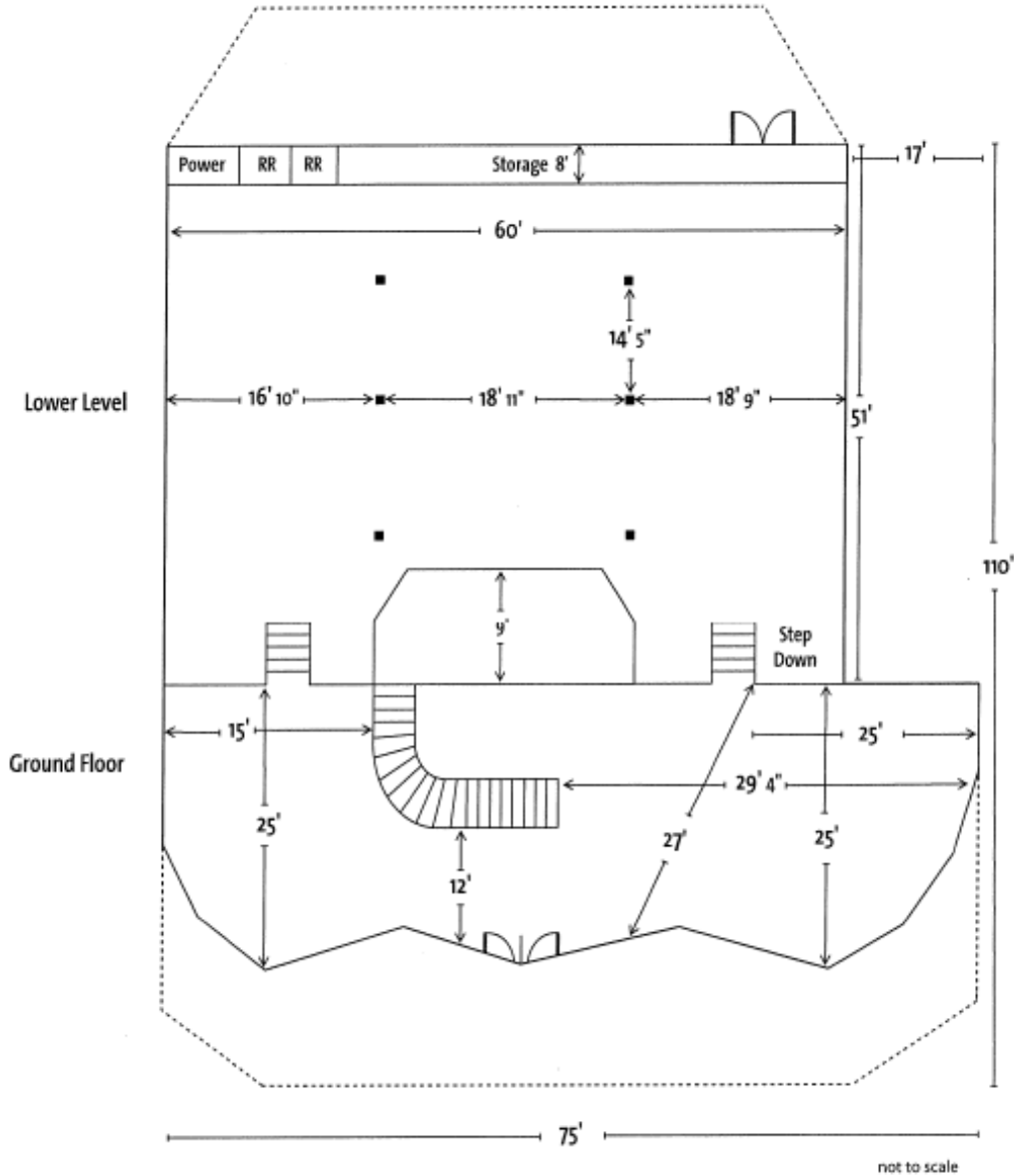

**NAI Capital**  
Commercial Real Estate Services, Worldwide.

No warranty, express or implied, is made as to the accuracy of the information contained herein. This information is submitted subject to errors, omissions, change of price, rental or other conditions, withdrawal without notice, and is subject to any special listing conditions imposed by our principals. Cooperating brokers, buyers, tenants and other parties who receive this document should not rely on it, but should use it as a starting point of analysis, and should independently confirm the accuracy of the information contained herein through a due diligence review of the books, records, files and documents that constitute reliable sources of the information described herein.



For information, please contact your exclusive listing agent:  
**J. Richard Leyner**  
Senior Vice President  
818 742 1638  
jrleyner@naicapital.com  
DRE #00716540

16001 Ventura Blvd., Suite 200  
Encino, California 91436  
tel 818 905 2400  
fax 818 905 2425  
www.naicapital.com

For Lease

# 19855 Ventura Boulevard

Woodland Hills, CA 91364

19855 Ventura Boulevard, Woodland Hills | Second Floor

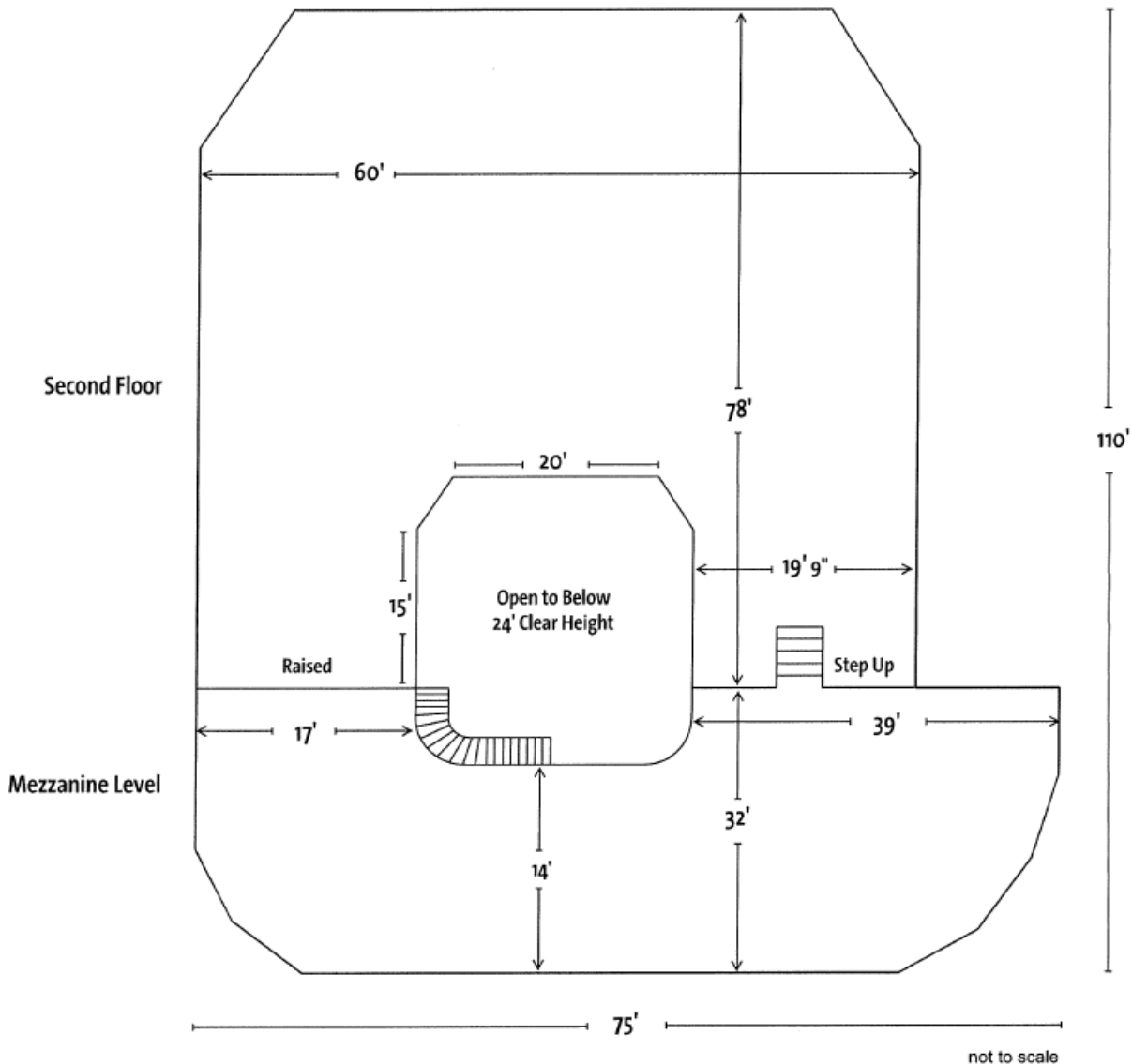

**NAI Capital**  
Commercial Real Estate Services, Worldwide.

No warranty, express or implied, is made as to the accuracy of the information contained herein. This information is submitted subject to errors, omissions, change of price, rental or other conditions, withdrawal without notice, and is subject to any special listing conditions imposed by our principals. Cooperating brokers, buyers, tenants and other parties who receive this document should not rely on it, but should use it as a starting point of analysis, and should independently confirm the accuracy of the information contained herein through a due diligence review of the books, records, files and documents that constitute reliable sources of the information described herein.



For information, please contact your exclusive listing agent:  
**J. Richard Leyner**  
Senior Vice President  
818 742 1638  
jrleyner@naicapital.com  
DRE #00716540

16001 Ventura Blvd., Suite 200  
Encino, California 91436  
tel 818 905 2400  
fax 818 905 2425  
www.naicapital.com