

Available for Lease

Yucaipa Professional Center

13391 California St. Yucaipa, CA 92399



HIGHLIGHTS

- Medical or General Office Buildings
- 13,088 Total SF Available
- Currently Leased Out 1500 SF
- Lease rate \$1.25 psf plus .35 psf NNN Charge
- Divisible from 500 to 13,088 SF
- 5:1,000 SF Parking Ratio
- Signage Available
- Separate Large Kitchen / Break room area.
- Landscaped courtyard and grounds



Commercial Real Estate Services, Worldwide.

No warranty, express or implied, is made as to the accuracy of the information contained herein. This information is submitted subject to errors, omissions, change of price, rental or other conditions, withdrawal without notice, and is subject to any special listing conditions imposed by our principals. Cooperating brokers, buyers, tenants and other parties who receive this document should not rely on it, but should use it as a starting point of analysis, and should independently confirm the accuracy of the information contained herein through a due diligence review of the books, records, files and documents that constitute reliable sources of the information described herein.

For information, please contact your exclusive listing agent

Felipe A. Espinoza
Associate
909.213.0634
fespinoza@naicapital.com

2280 Market St., Suite 150
Riverside, California 92501
tel 951 346 0800
fax 951 346 0801

Great Medical or General Office Space

Yucaipa/CA

Property Floor Plan

① Main Building 7,038 SF Net Rentable / 6,820 SF Usable



② 2nd Building 4,636 SF Net Rentable / 4,482 SF Usable

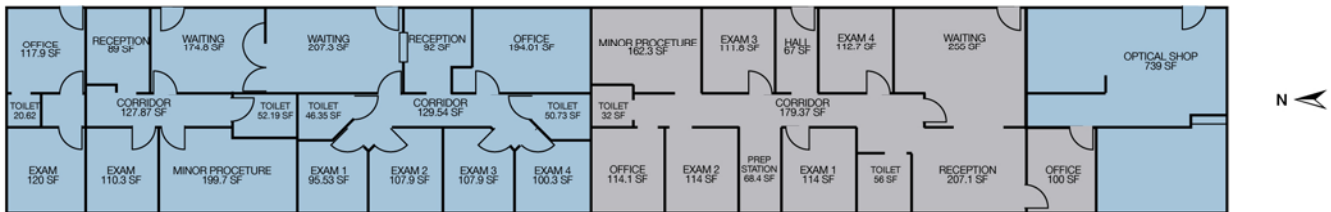

③ Center Building 2,914 SF Net Rentable / 2,862 SF Usable

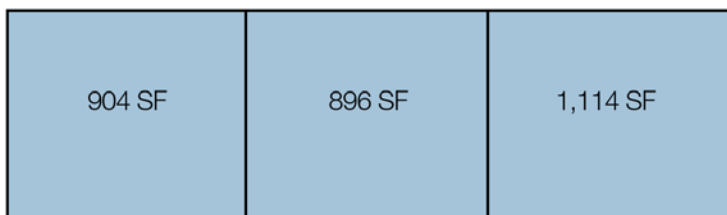

NAI Capital

Commercial Real Estate Services, Worldwide.

No warranty, express or implied, is made as to the accuracy of the information contained herein. This information is submitted subject to errors, omissions, change of price, rental or other conditions, withdrawal without notice, and is subject to any special listing conditions imposed by our principals. Cooperating brokers, buyers, tenants and other parties who receive this document should not rely on it, but should use it as a starting point of analysis, and should independently confirm the accuracy of the information contained herein through a due diligence review of the books, records, files and documents that constitute reliable sources of the information described herein.

For information, please contact your exclusive listing agent

Felipe A. Espinoza
Associate
909.213.0634
fespinoza@naicapital.com

2280 Market Street, Suite 150
 Riverside, California 92501
 tel 951 346 0800
 fax 951 346 0801