

AVAILABLE FOR LEASE

Prominent Grocery/Drugstore Anchored Neighborhood Center



7048 Sepulveda Boulevard ■ Van Nuys, California
SEC Sepulveda Boulevard and Sherman Way

HIGHLIGHTS

- Approximately 1,473 square feet available for restaurant or retail use
- 95,000 sq. ft. Neighborhood Center anchored by: Jons Marketplace, CVS Drug Store, Bank of America, Chase Bank and Union Bank
- Excellent access and visibility
- Parking ratio of 5.35/1000 sq. ft.
- Asking rent: \$2.25 PSF NNN

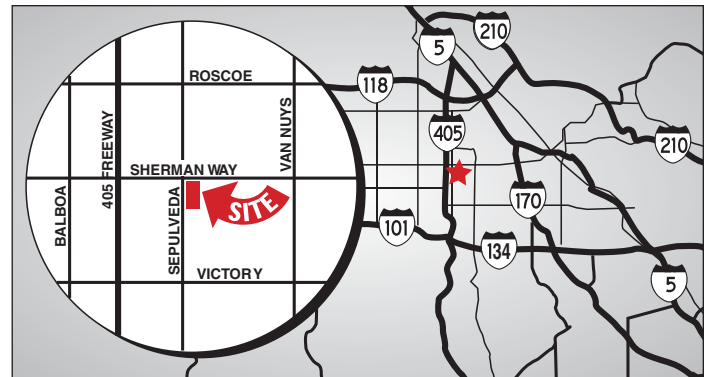

| DEMOGRAPHICS | | | |
|----------------|----------|----------|----------|
| | 1 Mile | 2 Miles | 3 Miles |
| Population | 46,283 | 143,177 | 305,312 |
| Avg. HH Income | \$51,230 | \$51,804 | \$59,809 |
| Employees | 14,606 | 66,761 | 112,827 |

| TRAFFIC COUNT | |
|---------------------------------|---------|
| North & Southbound on Sepulveda | 43,026 |
| East & Westbound on Sherman Way | 60,879 |
| Total vehicles per day | 103,905 |



Commercial Real Estate Services, Worldwide.

No warranty, express or implied, is made as to the accuracy of the information contained herein. This information is submitted subject to errors, omissions, change of price, rental or other conditions, withdrawal without notice, and is subject to any special listing conditions imposed by our principals. Cooperating brokers, buyers, tenants and other parties who receive this document should not rely on it, but should use it as a starting point of analysis, and should independently confirm the accuracy of the information contained herein through a due diligence review of the books, records, files and documents that constitute reliable sources of the information described herein.

For information, please contact your exclusive listing agent:

Steven H. Weiss
Senior Vice President
818.905.2400 x134
sweiss@naicapital.co
DRE License #00680554

16001 Ventura Blvd., Ste. 200
Encino, California 91436
tel 818 905 2400
fax 818 905 2425

7048 Sepulveda Blvd.

Van Nuys, California

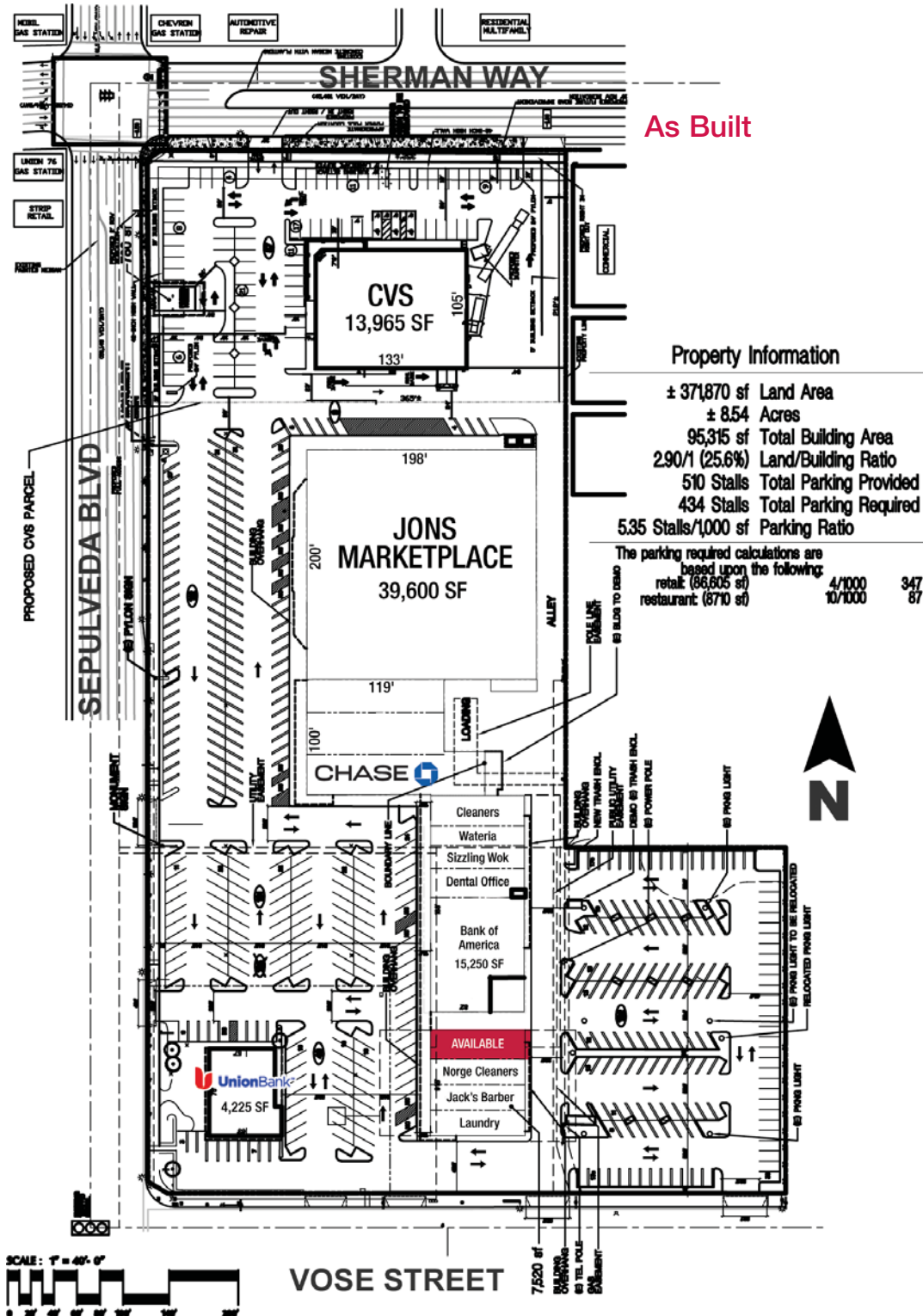

Commercial Real Estate Services, Worldwide.

No warranty, express or implied, is made as to the accuracy of the information contained herein. This information is submitted subject to errors, omissions, change of price, rental or other conditions, withdrawal without notice, and is subject to any special listing conditions imposed by our principals. Cooperating brokers, buyers, tenants and other parties who receive this document should not rely on it, but should use it as a starting point of analysis, and should independently confirm the accuracy of the information contained herein through a due diligence review of the books, records, files and documents that constitute reliable sources of the information described herein.

For information, please contact your exclusive listing agent:

Steven H. Weiss
Senior Vice President
 818.905.2400 x134
 sweiss@naicapital.co
 DRE License #00680554

16001 Ventura Blvd., Ste. 200
 Encino, California 91436
 tel 818 905 2400
 fax 818 905 2425