

# Ramona Crossings

For Lease

3,130 SF with Drive Thru



671 N. State Street  
San Jacinto, California 92583

## Lease Highlights

- 3,130 SF with Drive-thru (Divisible to 1,750 SF and 1,380 SF)
- Close proximity to anchored Stater Bros and Rite-Aid shopping centers
- Tenants located within the shopping center - McDonald's, Taco Bell and Dominos
- Located on the going to work side of the street
- Excellent location for QSR tenants
- Contact broker regarding economics

## Demographics

	1 Mile	3 Miles	5 Miles
Total Households	4,355	19,551	48,039
Total Population	14,195	60,951	139,334
Average HH Income	\$57,722	\$57,524	\$54,016

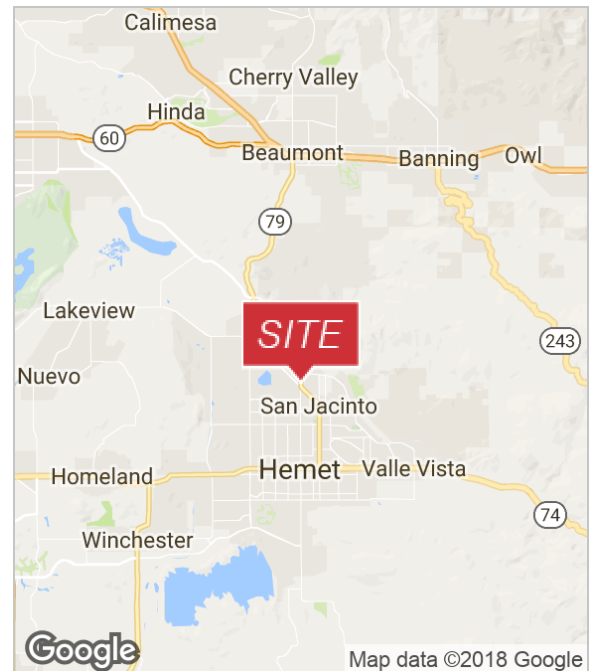

For more information

**Fred Encinas**

O: 909.243.7639  
fencinas@naicapital.com | CA #00582260

**Steve Weiss**

O: 818.905.2400 x1634  
sweiss@naicapital.com | CA #00680554

No warranty, express or implied, is made as to the accuracy of the information contained herein. This information is submitted subject to errors, omissions, change of price, rental or other conditions, withdrawal without notice, and is subject to any special listing conditions imposed by our principals. Cooperating brokers, buyers, tenants and other parties who receive this document should not rely on it, but should use it as a starting point of analysis, and should independently confirm the accuracy of the information contained herein through a due diligence review of the books, records, files and documents that constitute reliable sources of the information described herein. Logos are for identification purposes only and may be trademarks of their respective companies. NAI Capital, Inc. CA BRE Lic. #01990696.

For Lease

# Ramona Crossings

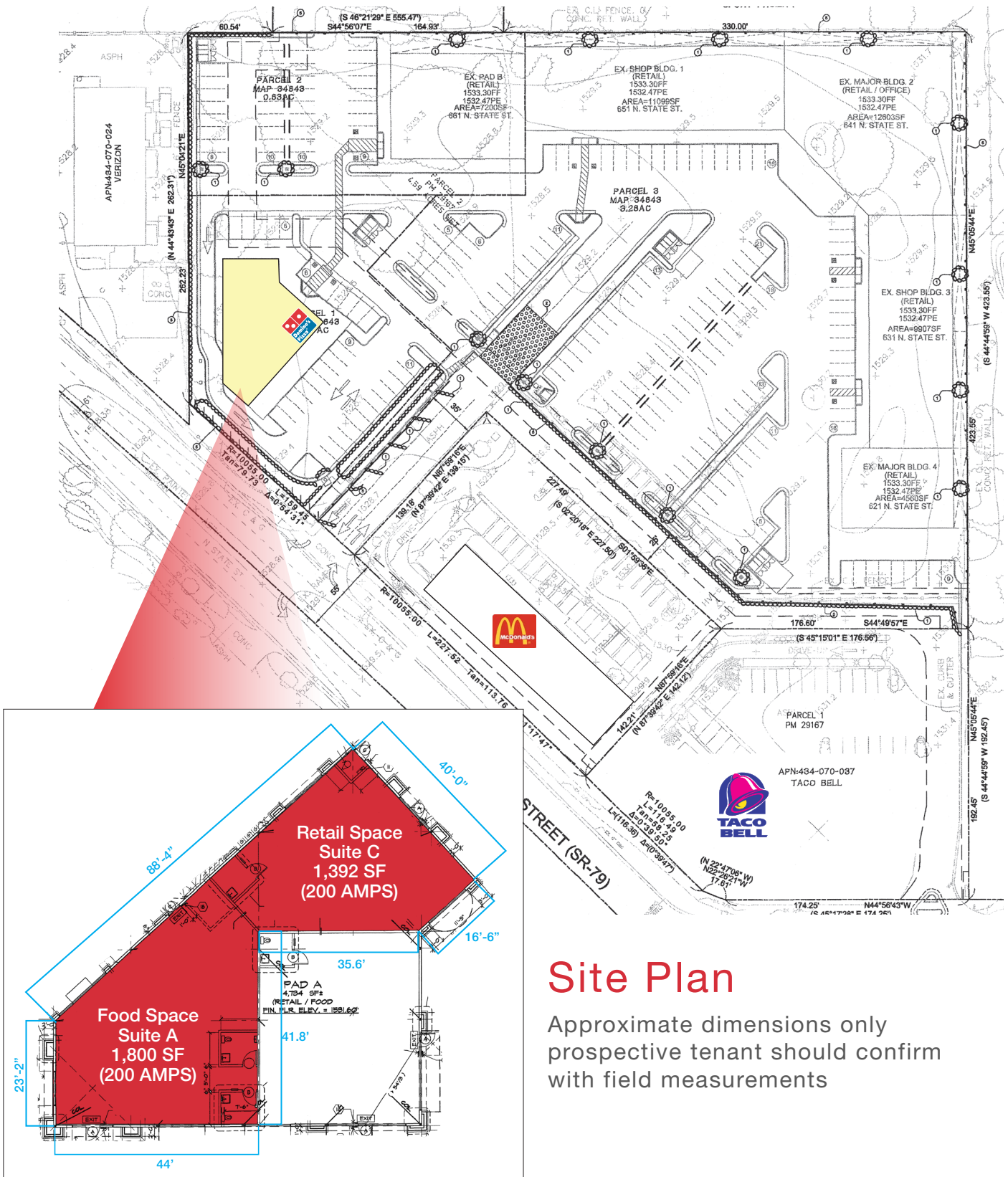

## Site Plan

Approximate dimensions only  
prospective tenant should confirm  
with field measurements

**Fred Encinas**  
909.243.7639  
fencinas@naicapital.com  
CA CalBRE #00582260

**Steve Weiss**  
818.905.2400 x1634  
sweiss@naicapital.com  
CA CalBRE #00680554

**NAI Capital**  
COMMERCIAL REAL ESTATE SERVICES, WORLDWIDE

NO WARRANTY, EXPRESS OR IMPLIED, IS MADE AS TO THE ACCURACY OF THE INFORMATION CONTAINED HEREIN. THIS INFORMATION IS SUBMITTED SUBJECT TO ERRORS, OMISSIONS, CHANGE OF PRICE, RENTAL OR OTHER CONDITIONS, WITHDRAWAL WITHOUT NOTICE, AND IS SUBJECT TO ANY SPECIAL LISTING CONDITIONS IMPOSED BY OUR PRINCIPALS, COOPERATING BROKERS, BUYERS, TENANTS AND OTHER PARTIES WHO RECEIVE THIS DOCUMENT SHOULD NOT RELY ON IT, BUT SHOULD USE IT AS A STARTING POINT OF ANALYSIS, AND SHOULD INDEPENDENTLY CONFIRM THE ACCURACY OF THE INFORMATION CONTAINED HEREIN THROUGH A DUE DILIGENCE REVIEW OF THE BOOKS, RECORDS, FILES AND DOCUMENTS THAT CONSTITUTE RELIABLE SOURCES OF THE INFORMATION DESCRIBED HEREIN. LOGOS ARE FOR IDENTIFICATION PURPOSES ONLY AND MAY BE TRADEMARKS OF THEIR RESPECTIVE COMPANIES. NAI CAPITAL, INC. CA BRE LIC. #01990696.