

For Sale

Atwater Village
Sale Price: \$1,999,000

1,200 SF Building - 4,167 SF Lot

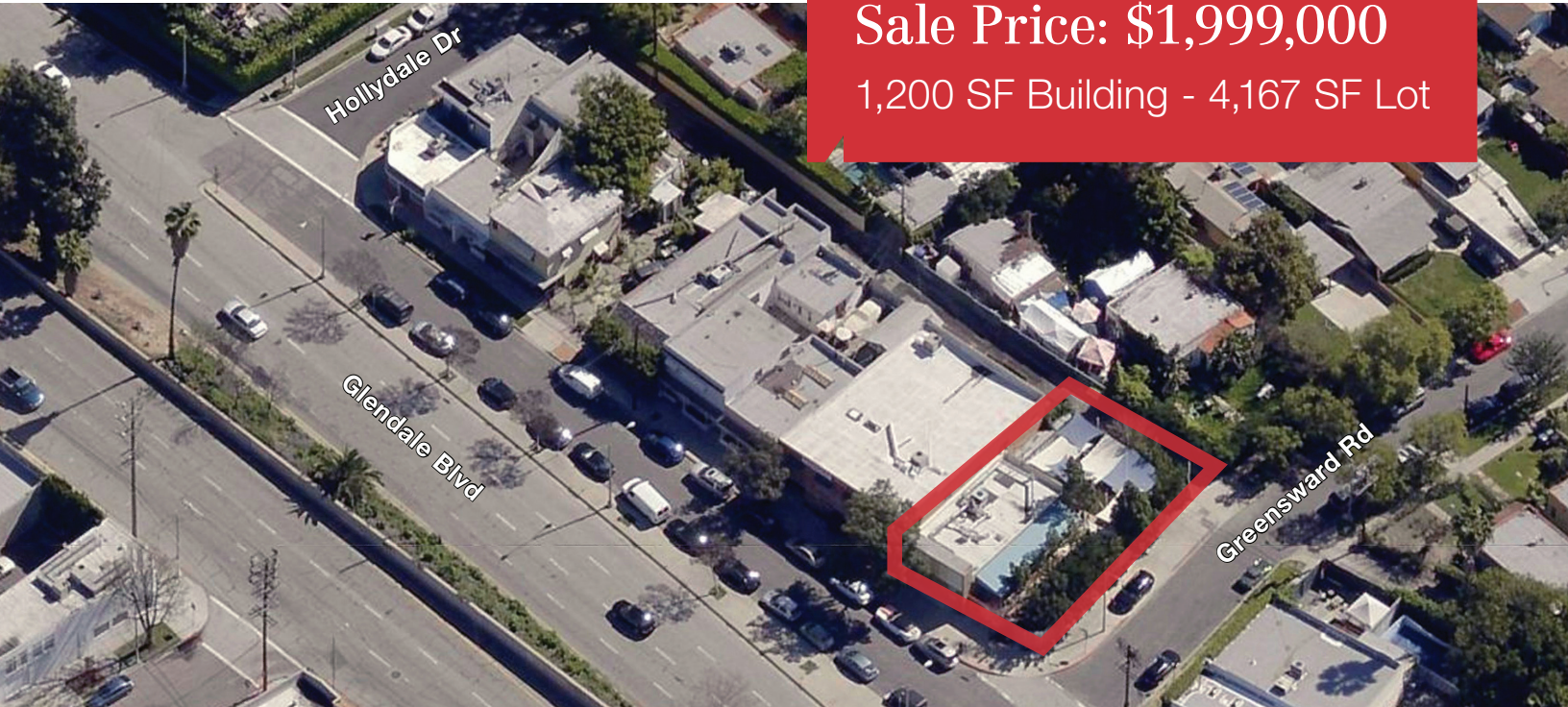

3010 Glendale Blvd

Los Angeles, CA 90039

Property Highlights

- Restaurant or school possible use
- Previously a well-known Licensed Preschool
- High visibility corner parcel
- Glendale Blvd. Frontage
- Close proximity to the 5, 110 & 134 Freeways
- Near Griffith Park & Dodger Stadium
- Currently C1.5 Zoning, allows for micro residential, restaurant, school & many other uses
- Close proximity to Glendale, Burbank and Downtown Los Angeles
- Atwater Village Community
- Small town atmosphere in the middle of the big city
- Walk, bike or drive to the hiking trails of Griffith Park, tennis courts & playgrounds
- Atwater Village Voted "Hippest Community in L.A." by LA Weekly & Curbed LA

- 1 block from the LA River Redevelopment & Revitalization
- Walking distance to Atwater's award winning restaurants, bakeries and coffee houses
- Minutes away from Glendale Amtrack Line, LA River bike path and micro parks
- Walking distance to popular Atwater Village Farmer's Market

Looking for a restaurant or school site?

- Current building construction is permitted with the City of LA
- New Roof
- New Dual Zone HVAC
- City of LA flood zone drainage system installed
- New Plumbing
- New Electric & Meters
- ADA Restrooms
- Large outdoor gardens and seating areas perfect for restaurant patios

For More Information:

MATT EHRLICH
Senior Associate
818.933.2364
mehrlich@naicapital.com
CA BRE Lic. #01936772

16001 Ventura Blvd.
Suite 200
Encino, CA 91436
818 905 2400
naicapital.com

No warranty, express or implied, is made as to the accuracy of the information contained herein. This information is submitted subject to errors, omissions, change of price, rental or other conditions, withdrawal without notice, and is subject to any special listing conditions imposed by our principals. Cooperating brokers, buyers, tenants and other parties who receive this document should not rely on it, but should use it as a starting point of analysis, and should independently confirm the accuracy of the information contained herein through a due diligence review of the books, records, files and documents that constitute reliable sources of the information described herein. NAI Capital CA BRE #01990696

For Sale

Atwater Village

Sale Price: \$1,999,000

1,200 SF Building - 4,167 SF Lot

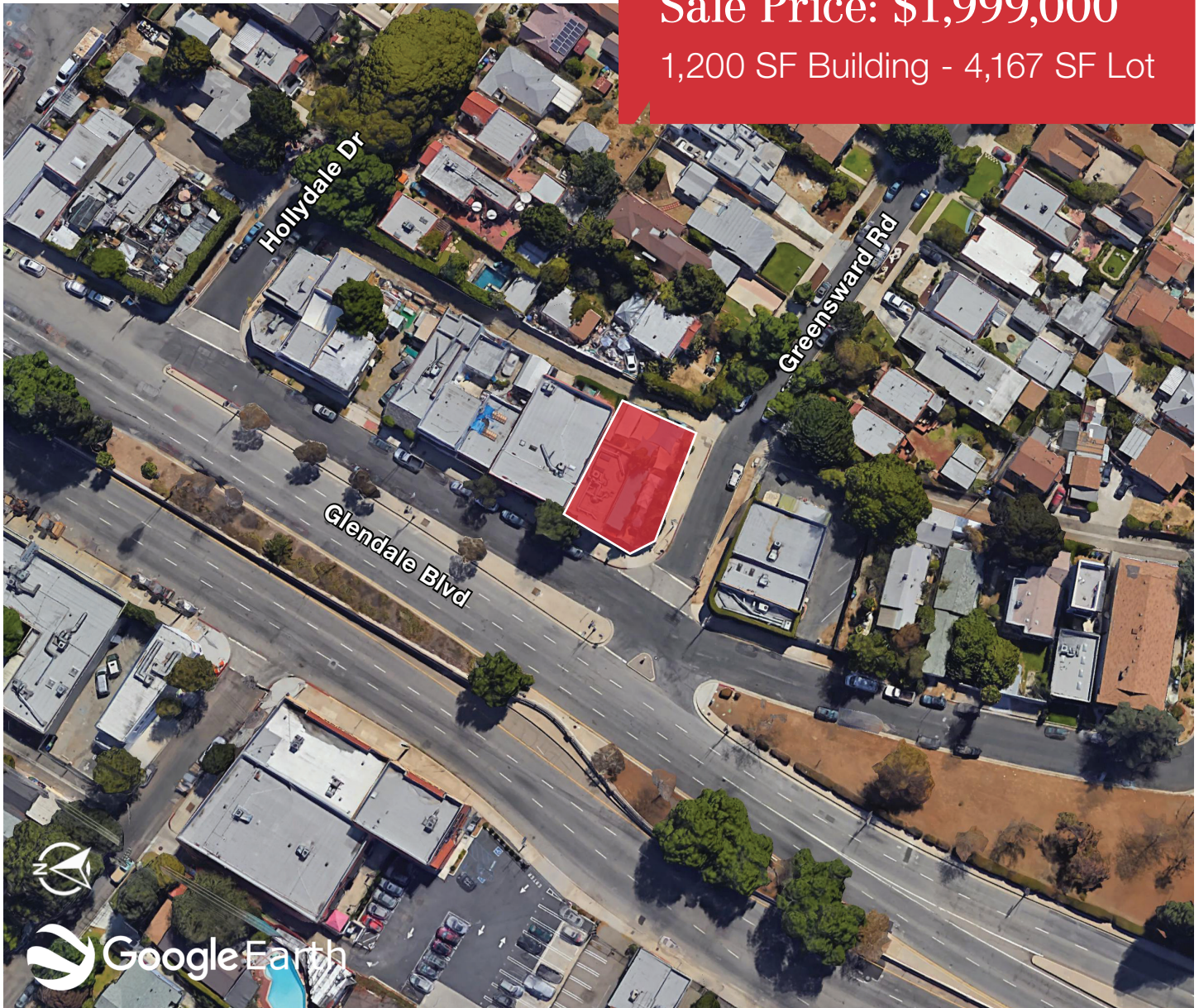

Address

APN No.

Building Size

Lot Size

3010 Glendale Blvd.
Los Angeles, CA 90039

5437-018-031

1,200 SF

4,167 SF

For More Information:

MATT EHRLICH

Senior Associate

818.933.2364

mehrllich@naicapital.com

CA BRE Lic. #01936772

16001 Ventura Blvd.

Suite 200

Encino, CA 91436

818 905 2400

naicapital.com

No warranty, express or implied, is made as to the accuracy of the information contained herein. This information is submitted subject to errors, omissions, change of price, rental or other conditions, withdrawal without notice, and is subject to any special listing conditions imposed by our principals. Cooperating brokers, buyers, tenants and other parties who receive this document should not rely on it, but should use it as a starting point of analysis, and should independently confirm the accuracy of the information contained herein through a due diligence review of the books, records, files and documents that constitute reliable sources of the information described herein. NAI Capital CA BRE #01990696

For Sale

Atwater Village

Sale Price: \$1,999,000

1,200 SF Building - 4,167 SF Lot



For More Information:

MATT EHRLICH
Senior Associate
818.933.2364
mehrlich@naicapital.com
CA BRE Lic. #01936772

16001 Ventura Blvd.
Suite 200
Encino, CA 91436
818 905 2400
naicapital.com

No warranty, express or implied, is made as to the accuracy of the information contained herein. This information is submitted subject to errors, omissions, change of price, rental or other conditions, withdrawal without notice, and is subject to any special listing conditions imposed by our principals. Cooperating brokers, buyers, tenants and other parties who receive this document should not rely on it, but should use it as a starting point of analysis, and should independently confirm the accuracy of the information contained herein through a due diligence review of the books, records, files and documents that constitute reliable sources of the information described herein. NAI Capital CA BRE #01990696

For Sale

Atwater Village
Sale Price: \$1,999,000

1,200 SF Building - 4,167 SF Lot



For More Information:

MATT EHRLICH
Senior Associate
818.933.2364
mehrlich@naicapital.com
CA BRE Lic. #01936772

16001 Ventura Blvd.
Suite 200
Encino, CA 91436
818 905 2400
naicapital.com

No warranty, express or implied, is made as to the accuracy of the information contained herein. This information is submitted subject to errors, omissions, change of price, rental or other conditions, withdrawal without notice, and is subject to any special listing conditions imposed by our principals. Cooperating brokers, buyers, tenants and other parties who receive this document should not rely on it, but should use it as a starting point of analysis, and should independently confirm the accuracy of the information contained herein through a due diligence review of the books, records, files and documents that constitute reliable sources of the information described herein. NAI Capital CA BRE #01990696

For Sale

Atwater Village
Sale Price: \$1,999,000

1,200 SF Building - 4,167 SF Lot

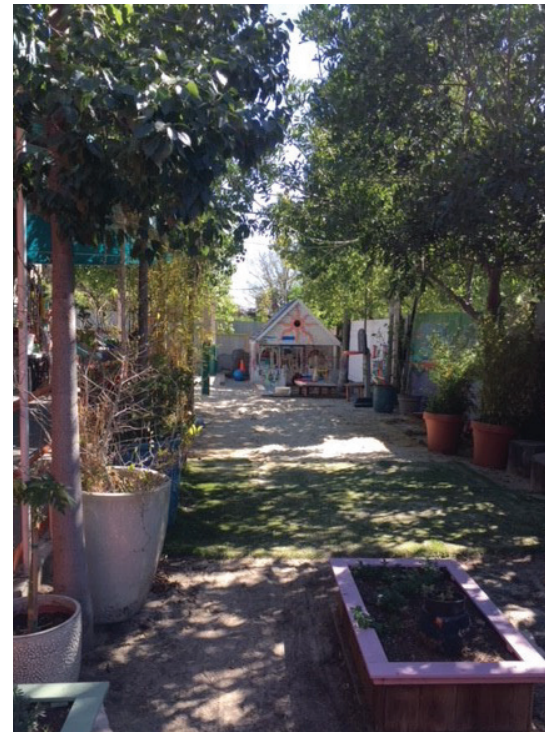

For More Information:

MATT EHRLICH
Senior Associate
818.933.2364
mehrlich@naicapital.com
CA BRE Lic. #01936772

16001 Ventura Blvd.
Suite 200
Encino, CA 91436
818 905 2400
naicapital.com

No warranty, express or implied, is made as to the accuracy of the information contained herein. This information is submitted subject to errors, omissions, change of price, rental or other conditions, withdrawal without notice, and is subject to any special listing conditions imposed by our principals. Cooperating brokers, buyers, tenants and other parties who receive this document should not rely on it, but should use it as a starting point of analysis, and should independently confirm the accuracy of the information contained herein through a due diligence review of the books, records, files and documents that constitute reliable sources of the information described herein. NAI Capital CA BRE #01990696

For Sale

Atwater Village

Sale Price: \$1,999,000

1,200 SF Building - 4,167 SF Lot



For More Information:

MATT EHRLICH
Senior Associate
818.933.2364
mehrlich@naicapital.com
CA BRE Lic. #01936772

16001 Ventura Blvd.
Suite 200
Encino, CA 91436
818 905 2400
naicapital.com

No warranty, express or implied, is made as to the accuracy of the information contained herein. This information is submitted subject to errors, omissions, change of price, rental or other conditions, withdrawal without notice, and is subject to any special listing conditions imposed by our principals. Cooperating brokers, buyers, tenants and other parties who receive this document should not rely on it, but should use it as a starting point of analysis, and should independently confirm the accuracy of the information contained herein through a due diligence review of the books, records, files and documents that constitute reliable sources of the information described herein. NAI Capital CA BRE #01990696