

FOR LEASE
Creative Office Space
In Historic Old Pasadena Building

LIVERY BUILDING

101 E. GREEN ST.



101 E. Green Street

Pasadena, CA 91105

Property Features

- Charming Building with Beautiful Leaded-Glass Windows
- Located in Old Town Pasadena
- Historic Building Originally Livery & Stables for Hotel Green and Castle Green
- Elevator Served
- Common Conference Room
- Walk to Restaurants and Shopping
- Close to City Parking Garage
- \$2.75/SF Full Service Gross

Suite 4:	365 SF	Avail 12/1/2015
Suite 7:	894 SF	Avail Immediately
Suite 11:	969 SF	Avail 6/1/2016
Suite 14:	2,576 SF	Avail 6/1/2016

R. Scott Martin, SIOR
Exec. Vice President
626 564 4800 x110
smartin@naicapital.com
BRE License #00992387

John Martin
Senior Vice President
626 564 4800 x107
jmartin@naicapital.com
BRE License #01280892

Sheri McCanless
Senior Vice President
626 893 1284
smccanless@naicapital.com
BRE License #01306519

No warranty, express or implied, is made as to the accuracy of the information contained herein. This information is submitted subject to errors, omissions, change of price, rental or other conditions, withdrawal without notice, and is subject to any special listing conditions imposed by our principals. Cooperating brokers, buyers, tenants and other parties who receive this document should not rely on it, but should use it as a starting point of analysis, and should independently confirm the accuracy of the information contained herein through a due diligence review of the books, records, files and documents that constitute reliable sources of the information described herein.

FOR LEASE
Creative Office Space
In Historic Old Pasadena Building



NAICapital
Commercial Real Estate Services, Worldwide.

R. Scott Martin, SIOR
Exec. Vice President
626 564 4800 x110
smartin@naicapital.com
BRE License #00992387

John Martin
Senior Vice President
626 564 4800 x107
jmartin@naicapital.com
BRE License #01280892

Sheri McCanless
Senior Vice President
626 893 1284
smccanless@naicapital.com
BRE License #01306519

FOR LEASE
Creative Office Space
In Historic Old Pasadena Building

Floor Plan: Suite 11

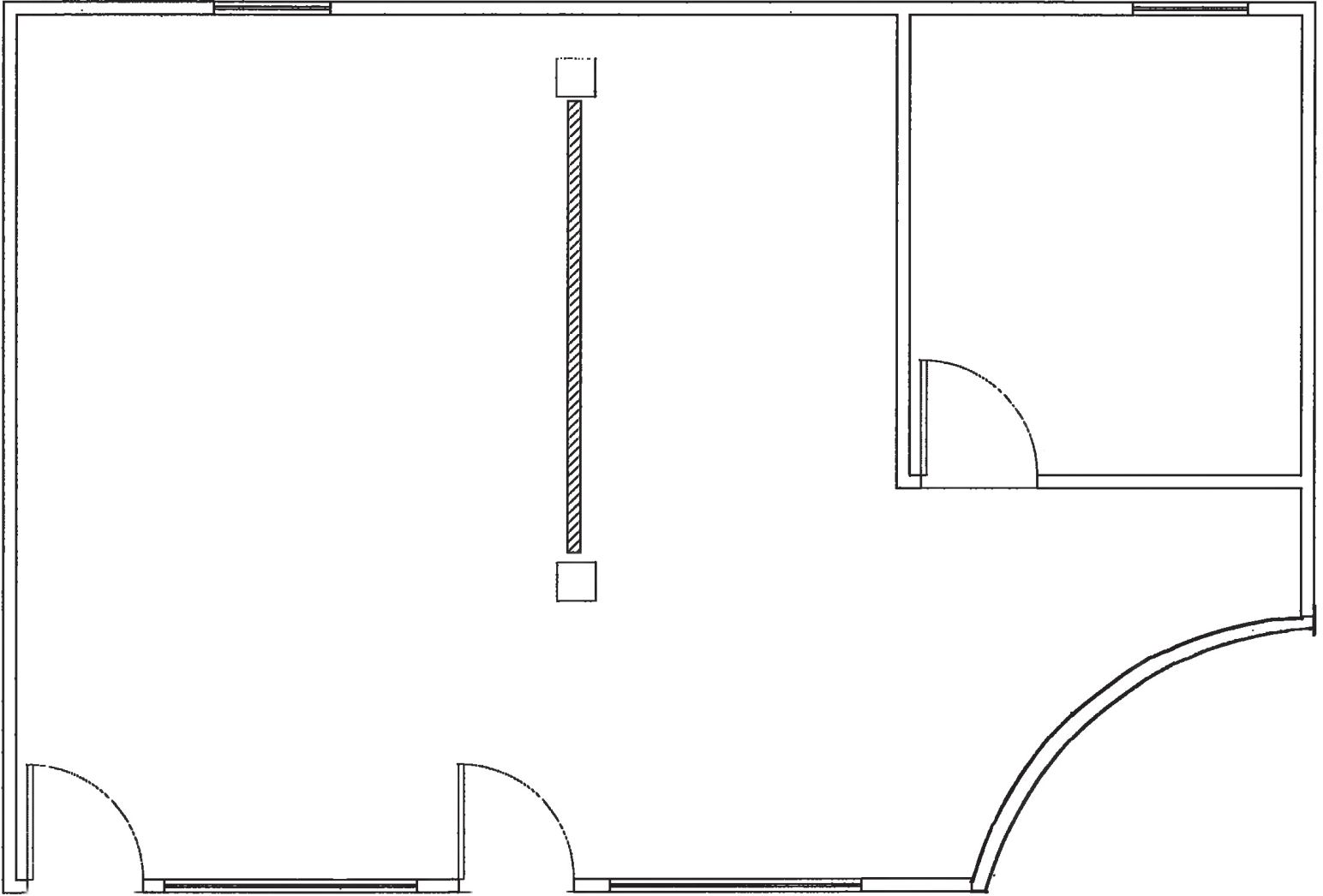

Not to Scale



Commercial Real Estate Services, Worldwide.

R. Scott Martin, SIOR
Exec. Vice President
626 564 4800 x110
smartin@naicapital.com
BRE License #00992387

John Martin
Senior Vice President
626 564 4800 x107
jmartin@naicapital.com
BRE License #01280892

Sheri McCanless
Senior Vice President
626 893 1284
smccanless@naicapital.com
BRE License #01306519