



297 N. Marengo Ave.

Pasadena, California 91101

Property Features

- Approximately 11,000 SF on the 2nd Floor
- Floor Currently in White Box Condition
- Building Signage Available
- Excellent 210 and 134 Freeway Access
- Covered Surface Parking
- Competitive Rental Rate



Carl E. Anderson
Executive Vice President
626 204 1510
canderson@naicapital.com
BRE License #00785702

John T. Martin
Senior Vice President
626 204 1503
jmartin@naicapital.com
BRE License #01280892

NAI Capital Pasadena
225 S Lake Ave
Suite 1170
Pasadena, CA 91101
www.naicapital.com

No warranty, express or implied, is made as to the accuracy of the information contained herein. This information is submitted subject to errors, omissions, change of price, rental or other conditions, withdrawal without notice, and is subject to any special listing conditions imposed by our principals. Cooperating brokers, buyers, tenants and other parties who receive this document should not rely on it, but should use it as a starting point of analysis, and should independently confirm the accuracy of the information contained herein through a due diligence review of the books, records, files and documents that constitute reliable sources of the information described herein.

297 N. Marengo Ave.

Pasadena, California 91101

For Lease Full Floor Office

Proposed Office Plan

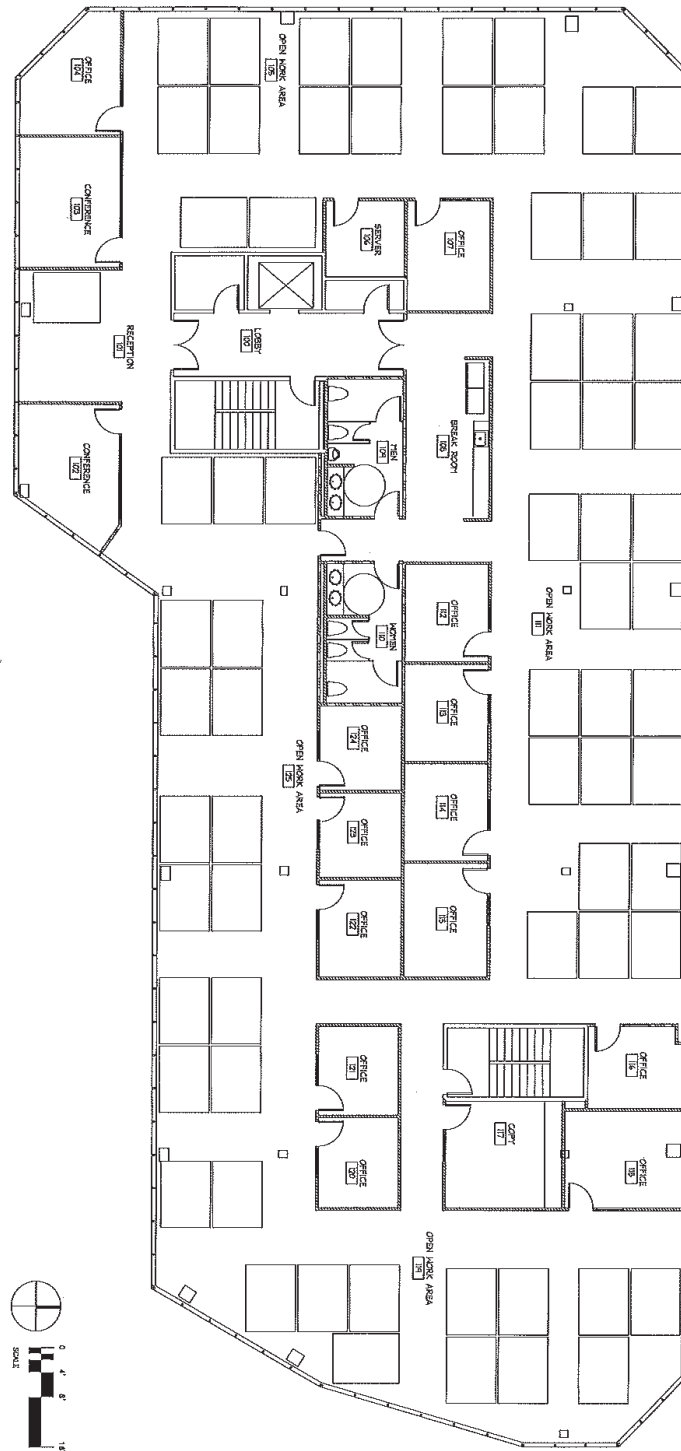

Commercial Real Estate Services, Worldwide.

Carl E. Anderson

Executive Vice President

626 204 1510

canderson@naicapital.com

BRE License #00785702

John T. Martin

Senior Vice President

626 204 1503

jmartin@naicapital.com

BRE License #01280892

NAI Capital Pasadena

225 S Lake Ave

Suite 1170

Pasadena, CA 91101

www.naicapital.com

No warranty, express or implied, is made as to the accuracy of the information contained herein. This information is submitted subject to errors, omissions, change of price, rental or other conditions, withdrawal without notice, and is subject to any special listing conditions imposed by our principals. Cooperating brokers, buyers, tenants and other parties who receive this document should not rely on it, but should use it as a starting point of analysis, and should independently confirm the accuracy of the information contained herein through a due diligence review of the books, records, files and documents that constitute reliable sources of the information described herein.