

**2375 Chicago Avenue, Riverside, CA 92507**

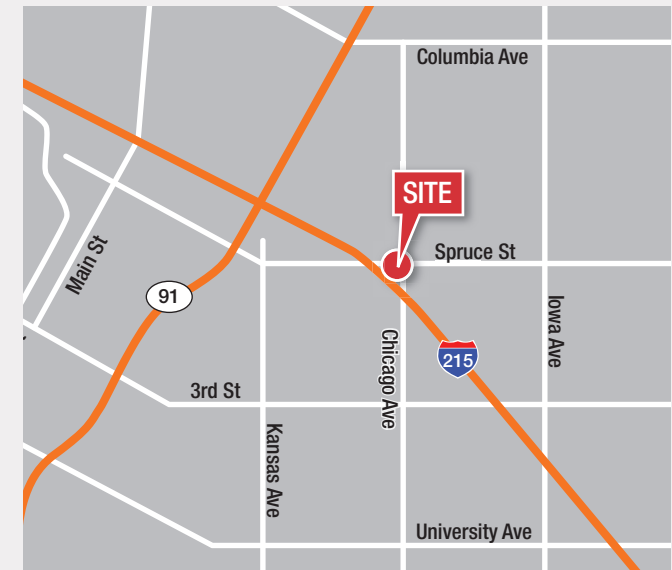

**Features**

- Multiple individual offices
- Conference room and kitchen
- Loading dock
- Ample parking w/gated yard
- 5 restrooms/2 showers
- Near 91, 215 and 60 Freeways
- Hunter Park area near downtown Riverside and University of California at Riverside



No warranty, express or implied, is made as to the accuracy of the information contained herein. This information is submitted subject to errors, omissions, change of price, rental or other conditions, withdrawal without notice, and is subject to any special listing conditions imposed by our principals. Cooperating brokers, buyers, tenants and other parties who receive this document should not rely on it, but should use it as a starting point of analysis, and should independently confirm the accuracy of the information contained herein through a due diligence review of the books, records, files and documents that constitute reliable sources of the information described herein.

For more information, please contact:

**Marcelle M. Williams**  
Senior Associate  
951-346-0800 ext. 1804  
mwilliams@naicapital.com  
CA BRE Lic. #00935159

**Jim Tang, CCIM**  
Senior Vice President  
909 243 7625  
jtang@naicapital.com  
CA BRE Lic. #00906662

North Haven Ave.  
Suite 400  
Ontario, CA 91764  
909 945 2339 tel  
[naicapital.com](http://naicapital.com)

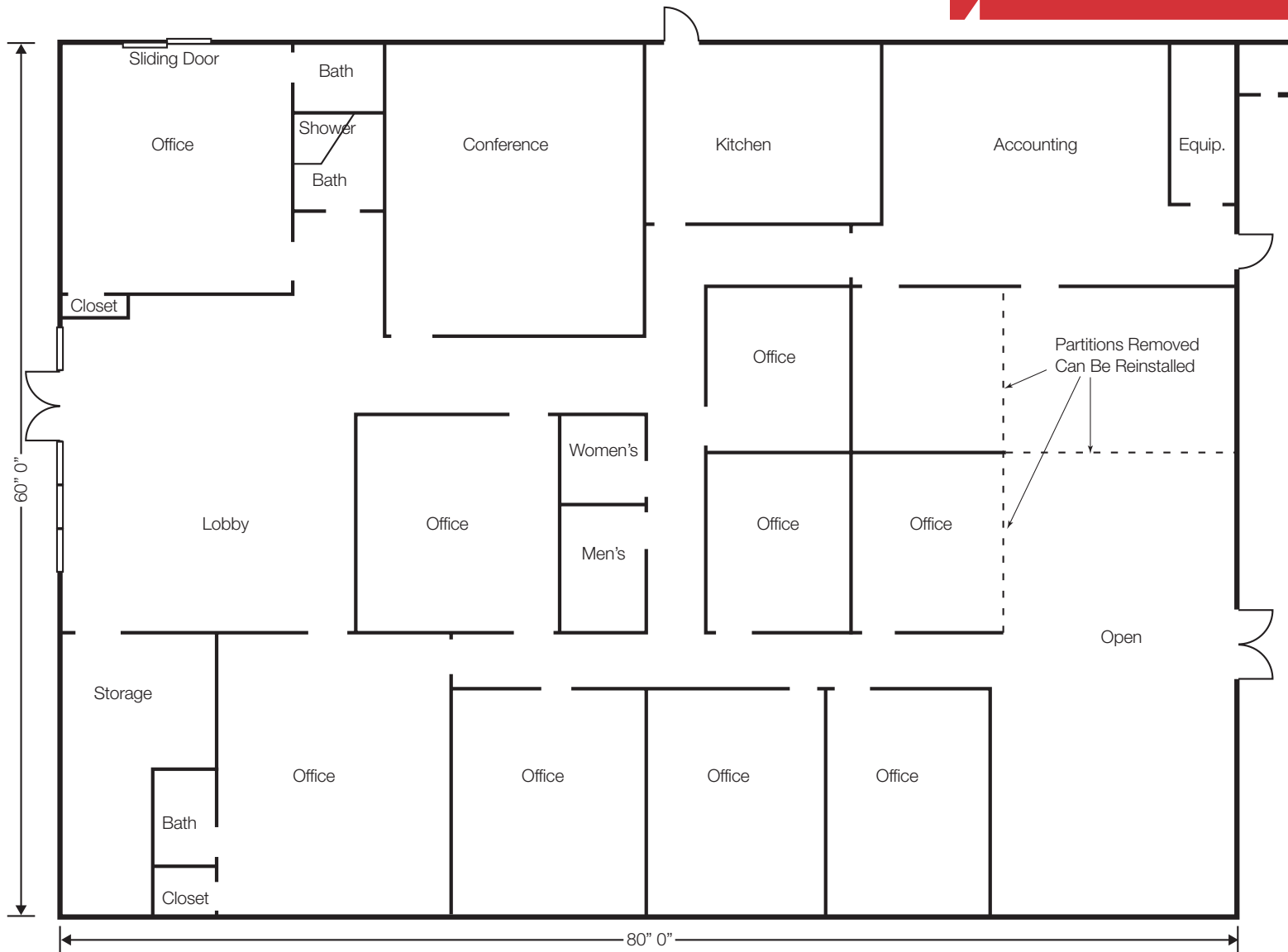

No warranty, express or implied, is made as to the accuracy of the information contained herein. This information is submitted subject to errors, omissions, change of price, rental or other conditions, withdrawal without notice, and is subject to any special listing conditions imposed by our principals. Cooperating brokers, buyers, tenants and other parties who receive this document should not rely on it, but should use it as a starting point of analysis, and should independently confirm the accuracy of the information contained herein through a due diligence review of the books, records, files and documents that constitute reliable sources of the information described herein.

For more information, please contact:

**Marcelle M. Williams**  
Senior Associate  
951-346-0800 ext. 1804  
mwilliams@naicapital.com  
CA BRE Lic. #00935159

**Jim Tang, CCIM**  
Senior Vice President  
909 243 7625  
jtang@naicapital.com  
CA BRE Lic. #00906662

North Haven Ave.  
Suite 400  
Ontario, CA 91764  
909 945 2339 tel  
[naicapital.com](http://naicapital.com)